

TO PROTECT YOUR HEALTH

SMART CAPS



CPS analitica, da oltre trent'anni leader nell'ambito della commercializzazione dei consumabili per Cromatografia e punto di riferimento per i laboratori chimici che utilizzano tali tecniche, è sempre più sensibile al discorso della sicurezza in laboratorio.

Costantemente aggiornata sulle più recenti tecnologie e sempre alla ricerca di prodotti innovativi che permettano di rendere il laboratorio un luogo "sicuro" e privo di qualsiasi tipologia di inquinamento, presenta il nuovo catalogo **SMART CAPS...**

... i tappi di sicurezza che aiutano a prevenire l'inquinamento da solventi.

La sicurezza nel Laboratorio

Le miscele eluenti di solventi per HPLC sono spesso lasciate aperte nella bottiglia posta sopra lo strumento oppure raccolte in una tanica a scarico comune.

Questa prassi è causa non solo di inquinamento da solventi ma anche di possibili modifiche alla composizione iniziale degli eluenti.

CPS analitica propone la soluzione ideale per entrambe le situazioni con i prodotti **SMART CAPS**.

Relativamente alle bottiglie di eluente fresco solitamente lasciate aperte, la soluzione è un tappo che permette l'aspirazione del liquido ma non la sua evaporazione; una valvolina a senso unico, montata sul tappo, permette di far entrare aria dall'ambiente esterno ma non viceversa.

I vantaggi di questo tipo di tappo sono innegabili:

- 1) fanno in modo che il solvente non evapori
- 2) mantengono per diversi giorni la concentrazione iniziale della fase mobile

Per quanto riguarda invece gli eluenti raccolti in taniche, la soluzione proposta da CPS per i tappi dello scarico prevede la possibilità di utilizzare una trappola a carbone attivo che permette di trattenerne il 95% ed oltre di vapori dannosi.

La cartuccia in carbone attivo non ha solo la funzione di trattenerne i solventi organici, ma riesce anche ad evitare qualsiasi forma di contro-pressione che potrebbe rovinare parti delicate del rivelatore.

La cartuccia di carbone attivo, una volta installata, ha una durata di 6 mesi.

Per i sistemi di raccolta che prevedono l'utilizzo di taniche, pratico risulta il tappo che, sempre munito di trappola a carbone attivo, presenta anche un galleggiante che segnala la quantità di liquido, evitando che la tanica venga riempita troppo.

SMART CAPS offre un'ampia gamma di tappi di scarico tali da rispondere alle esigenze di tutti i laboratori.



Per qualsiasi informazione tecnica e/o commerciale sui prodotti CPS analitica contattaci ai seguenti recapiti:

tel. 02.8954201 - fax 02.89542022
www.cps.it - e-mail: cps@cps.it

SUMMARY

HEALTHY AND WASTE CAPS, HOW DOES IT WORK ? 4-7

SMART HEALTHY CAPS

ANALYTICAL SYSTEM

Guide for installing a SHC	8
Smart Healthy Caps GL45	9
Starter Kit Smart Healthy Caps	10-11
GL45 thread with stopcock	12
Ground neck / Distri Smart	13
Smart Healthy Caps Septum	14

PREPARATIVE HPLC SYSTEM

GL45 thread	15
DIN 51/S55 & S60 thread	16
Safety funnel for preparative	17

ADAPTERS

Multi-Ways adapters	18
Operating principle	19
Classic adapters	20

BOTTLES

DURAN® glass bottle GL45	21
--------------------------	----

ACCESSORIES

Air check valves	22
Universal capillary connectors	23
Fittings and Ferrules	24
Tubing	25

SMART WASTE CAPS

ACTIVATED CHARCOAL CARTRIDGE

Cartridge for Cans	26
Cartridge for LC-MS	27
Adapters	28
Adapters for JUSTRITE® can	29

SMART WASTE CAPS THREADS

Guide for installing a SWC	30
DIN 51 / S55	31
GL45	32
Burkle S50	33
DIN 60 / S61	34
DIN 90 / S90	35
NALGENE® bottle	36
Level indicator	37

ADAPTERS

Special adapters	38
Adapters for cans fitted	39-40

ACCESSORIES

Universal capillary connectors	41
Container thread sizes	42
Starter Kit Smart Waste Caps	43
Threaded barbed fittings	44-45
Conectors and adapters	46
Tubing and blind plugs	47
Quick connect fittings	48-49

SAFETY FUNNELS

Funnel with Hinged lid	52-53
Funnel with stopcock	54
Funnel with ball valve	55-57
Electro conductive funnel	58
Sink for histological staining	59

CANS

Cans	60
Retention trays	61
Space-saving cans	61

INDEX 62-66

HEALTHY AND WASTE CAPS,

A ONE WAY AIR CHECK VALVE TECHNOLOGY

Before

DANGER !

Tubes slip out of place and air is suctioned in, so the process is interrupted.

After

SECURE

Tubes remain in position, thanks to a ferrule firmly tightened into a flanged fitting. Safe closure, no toxic vapours.

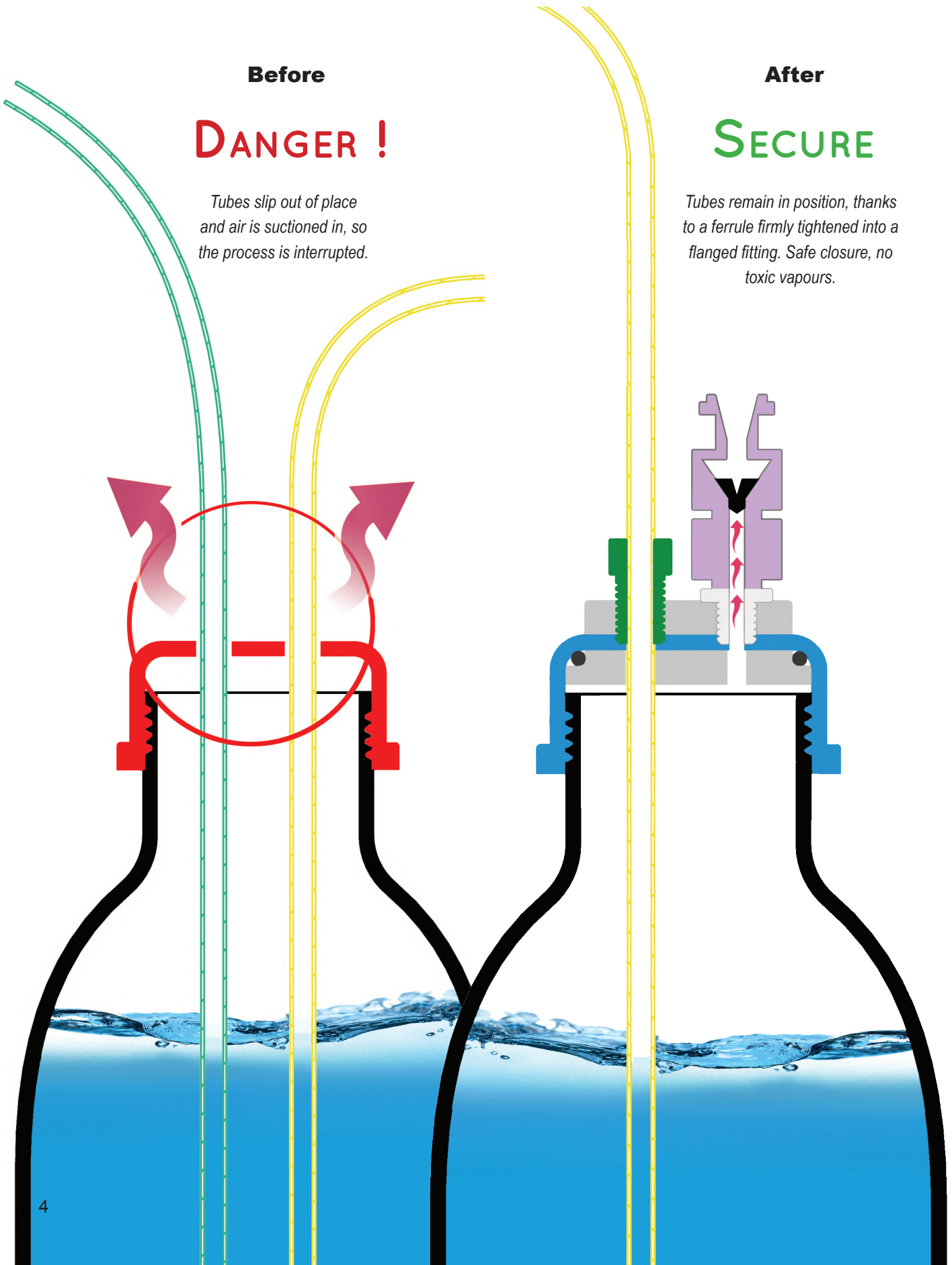

HOW DOES IT WORK ?

A TECHNOLOGY TO PROTECT YOUR HEALTH

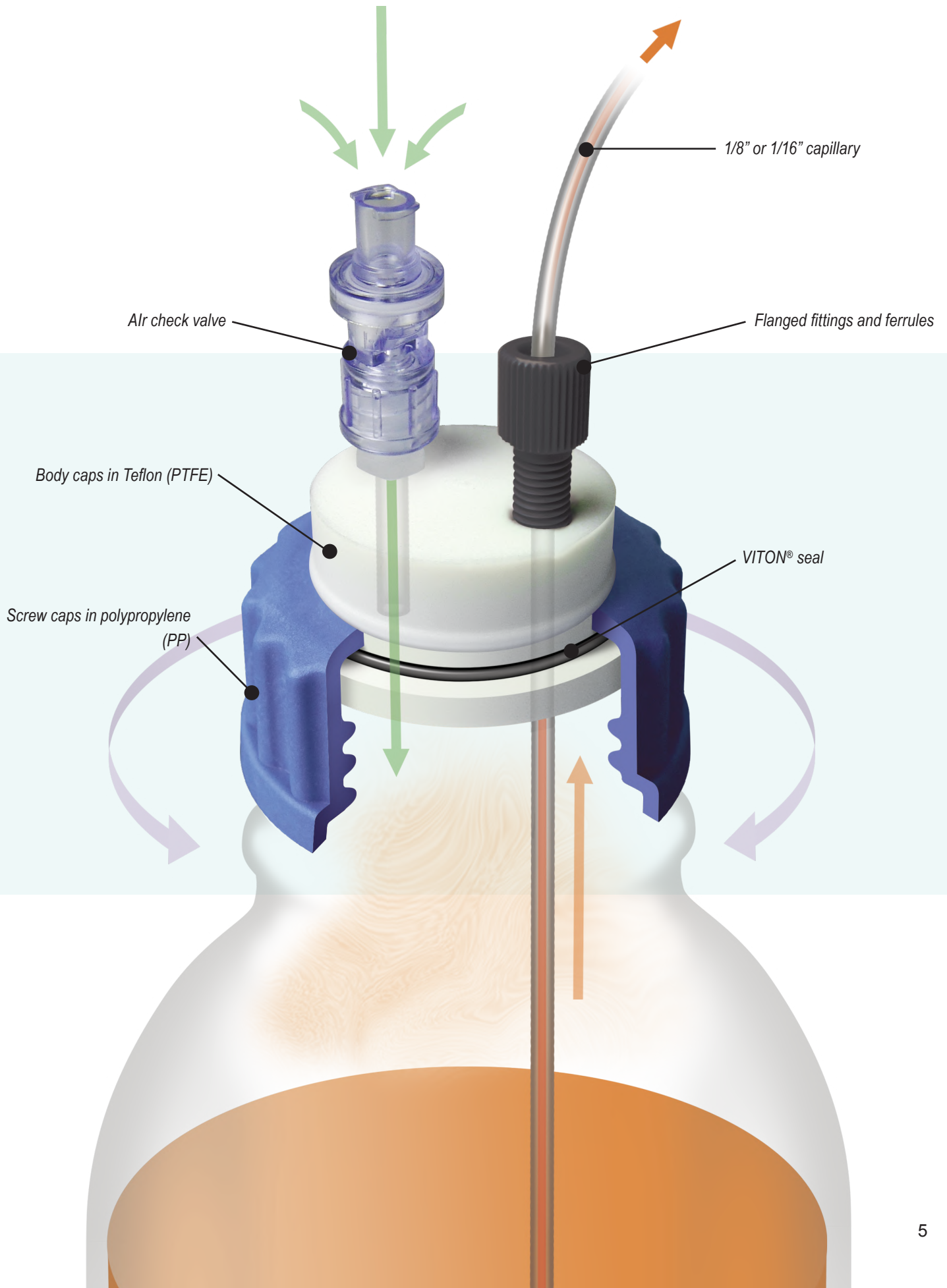

HEALTHY AND WASTE CAPS,

PRE-INSTALLED
ON YOUR
SMART HEALTHY CAPS!

A ONE WAY AIR CHECK VALVE TECHNOLOGY

Smart Healthy Caps are in response to modern laboratory safety regulations.

They are made of inert materials resistant to chemicals.

The use of a one-way air check valve allows for low cost safe and secure solvent extraction in your laboratory.

- ▶ No solvent evaporation. ✓
- ▶ Keep your concentration accurate for several days. ✓
- ▶ No mobile phase external contamination. ✓

360° ROTATION!

The rotation of the central part of the caps allows a good ease of installation, and also avoids any entanglement of tubes.

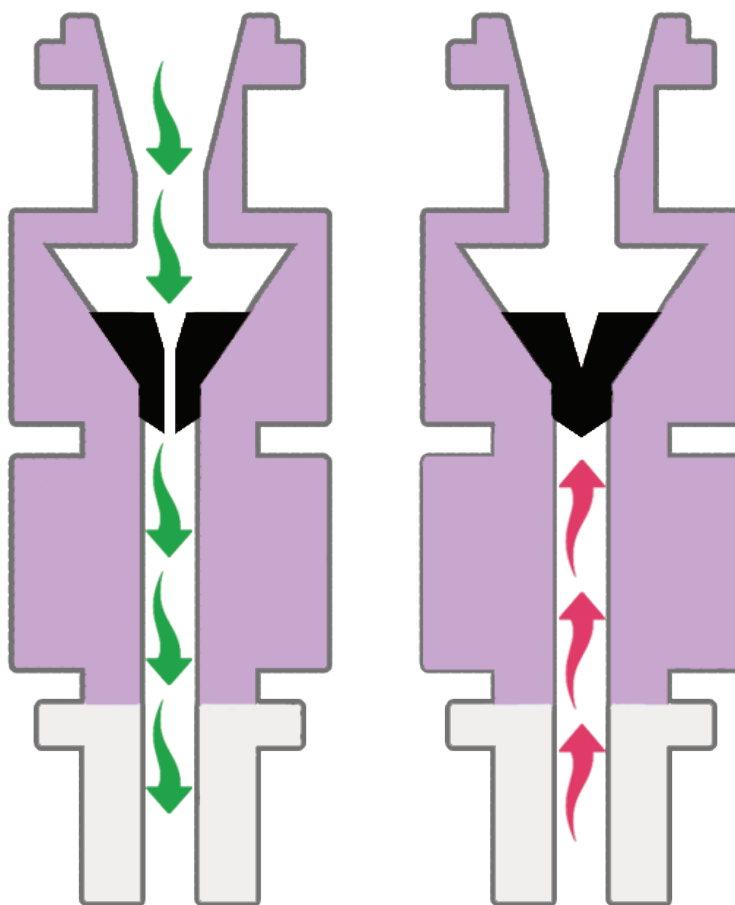

The membrane allows air to enter for pressure equalization.

The membrane is a barrier against eluent vapours and gas leaks.

HOW DOES IT WORK ?

A TECHNOLOGY TO PROTECT YOUR HEALTH

A Smart Waste Caps is formed by an airtight cap, drilled by a variable number of holes to host effluents tubes outgoing of the HPLC system.

The main piece is a cartridge filled with activated charcoal attached to the cap. This filter allows the absorption of 98% of the solvent's vapours released by the solvent's can.

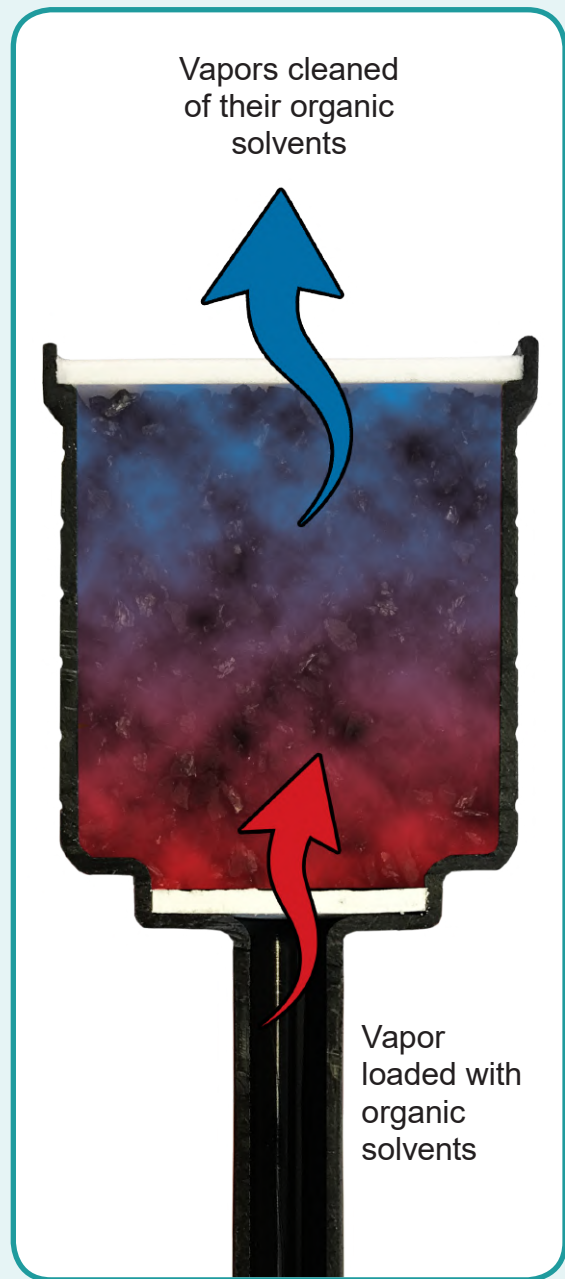
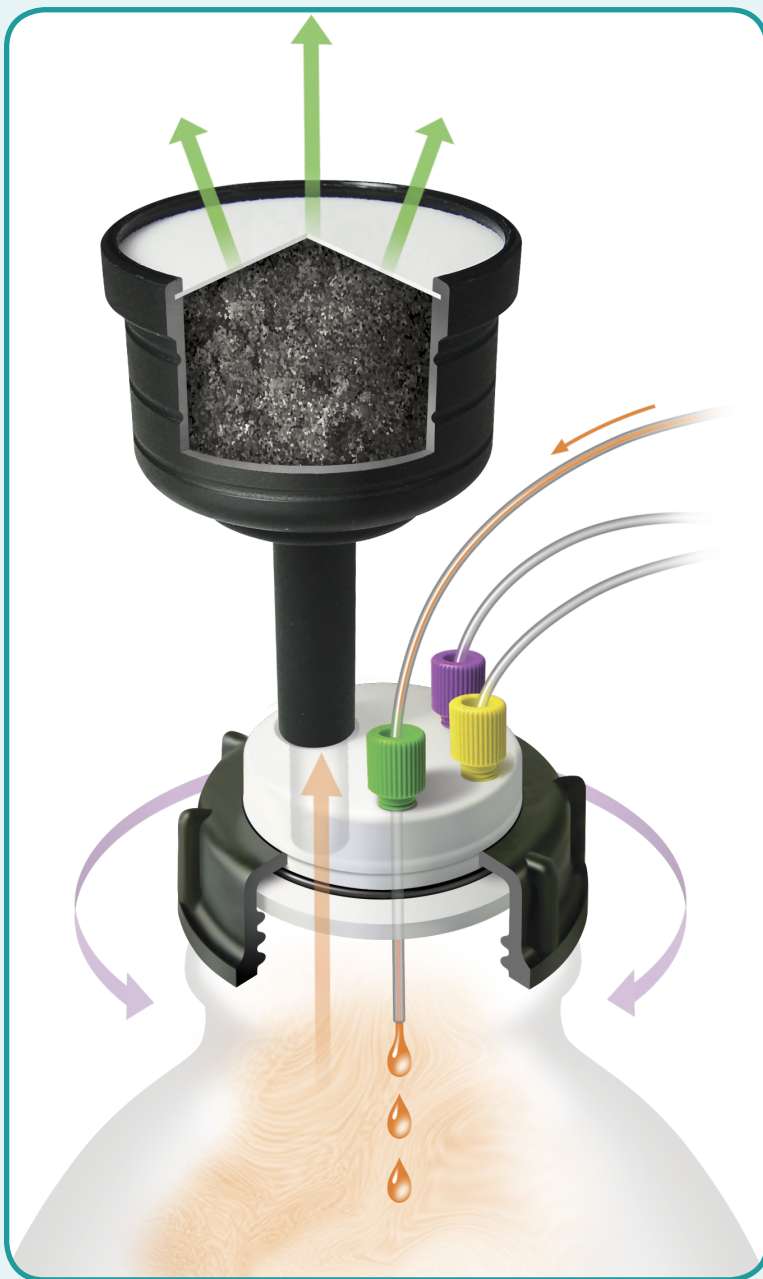

CPS analitica offers a diversified range of activated charcoal cartridge for the emission of eluent or solvent vapors; by special charcoal impregnation, the cartridges become an excellent barrier against concentrated acids or bases. See page 26.

SMART HEALTHY CAPS

GUIDE FOR INSTALLING A SMART HEALTHY CAPS

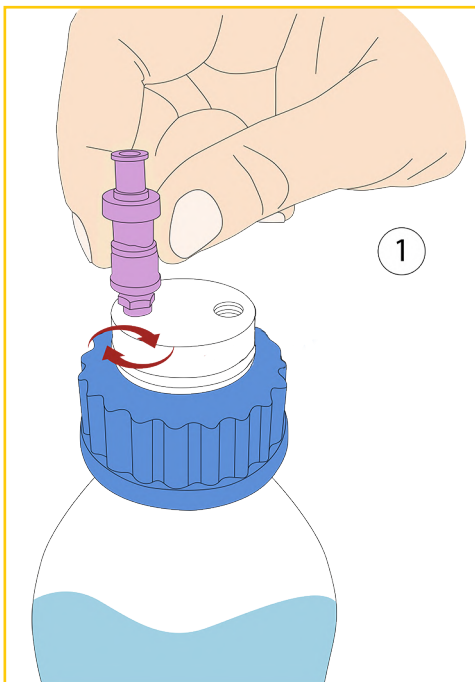

- Our Smart Healthy Caps are delivered with their pre-installed air check valves. However, if you need a valve that is resistant to polar solvent or amine derivatives vapors, simply unscrew the valve in place and then screw the new valve into its proper thread in the cap.

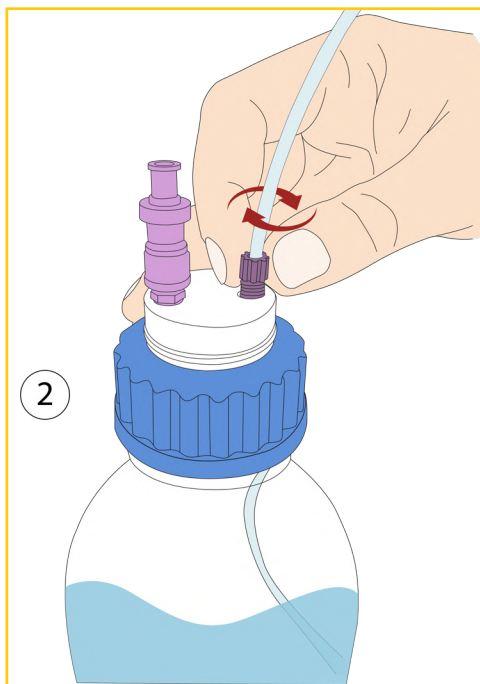

- Screw the universal capillary connector into its proper thread on your Smart Healthy Cap. (See our "Installing a universal capillary connector" guide on page 21 for more details)

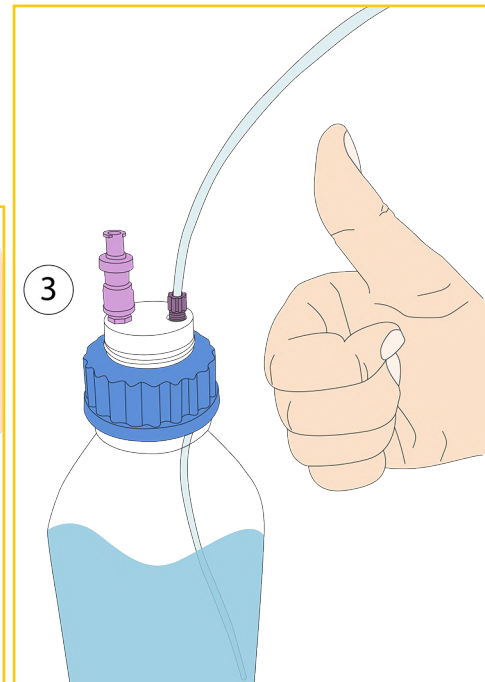

- Installation completed!

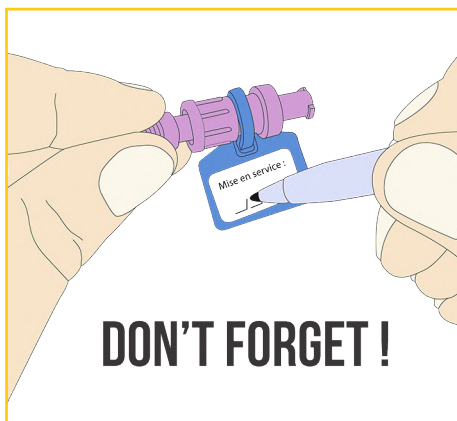
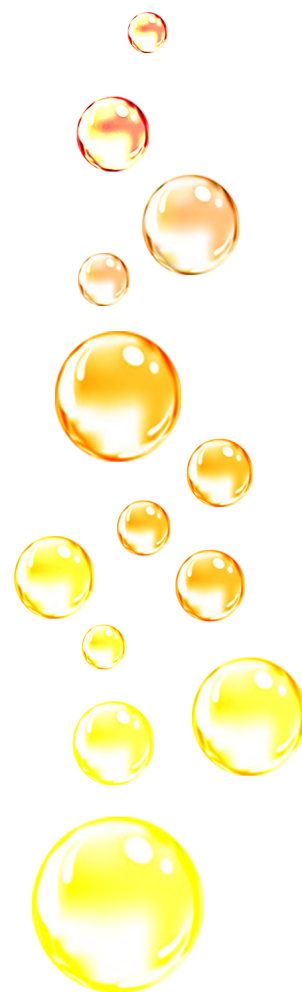

...And do not forget to indicate the date of commissioning of your air check valve in order to be able to anticipate its renewal!

SMART HEALTHY CAPS

ANALYTICAL SYSTEM

GL45 THREAD TYPE WITH AIR CHECK VALVE

Smart Healthy Caps for GL45 or DURAN® types are the most widespread in laboratories. Smart Healthy Caps are delivered with their universal capillary connector (external diameter 1/8" to 1/16") and their air check valve.



SHC-1



SHC-2



SHC-3



SHC-4

DESCRIPTION	FOR TUBE (OD)*	REFERENCE
Smart healthy caps GL45, 1 outlet and 1 air check valve	1/8"	SHC-1
Smart healthy caps GL45, 2 outlets and 1 air check valve	1/8"	SHC-2
Smart healthy caps GL45, 3 outlets and 1 air check valve	1/8"	SHC-3
Smart healthy caps GL45, 4 outlets and 1 air check valve	1/8"	SHC-4
Smart healthy caps GL45, 5 outlets and 1 air check valve	1/8"	SHC-5



SHC-5

* For another diameter, precise it when you order it.

NEW: Choose the color of your caps, for exemple choose it according to the solvent in your bottle.



R*



G*



Y*



P*

Add at the end of the reference the letter corresponding to the color you want. Caps are delivered in blue without any indications from you. Exemple for a green cap : **SHC-1-G**

* Color Code

SMART HEALTHY CAPS

STARTER KIT FOR SMART HEALTHY CAPS

WITHOUT BOTTLES

These kits have everything you need to discover our products with attractive prices.



DESCRIPTION	FOR TUBE (OD)*	REFERENCE
4x Smart Healthy Caps GL45, 1 outlet & 1 air check valve	1/8"	KIT-SHC-1
4x Smart Healthy Caps GL45, 2 outlets & 1 air check valve & 4 plugs*	1/8"	KIT-SHC-2
4x Smart Healthy Caps GL45, 3 outlets & 1 air check valve & 8 plugs*	1/8"	KIT-SHC-3



Plugs are useful if you need to block an outlet



SMART HEALTHY CAPS

STARTER KIT FOR SMART HEALTHY CAPS

WITH BOTTLES



DESCRIPTION	FOR TUBE (OD)*	REFERENCE
4x Clear glass bottles, 4x Smart Healthy Caps GL45, 2 outlets & 1 air check valve & 4 plugs*	1/8"	KITB-4SHC-2
5x Clear glass bottles, 5x Smart Healthy Caps GL45, 2 outlets & 1 air check valve & 5 plugs*	1/8"	KITB-5SHC-2



SMART HEALTHY CAPS

GL45 THREAD WITH STOPCOCK

GL45 Smart Healthy Caps with a stopcock offer more flexibility, without air bubbles inside the tubing.
 Smart Healthy Caps are delivered with their fittings 1/8" (external diameter 3,2 mm).



SHC-V1



SHC-V4

DESCRIPTION	FOR TUBE (OD)*	REFERENCE
Smart healthy caps GL45, 1 outlet with shut-off and 1 air check valve	1/8"	SHC-V1
Smart healthy caps GL45, 2 outlets with shut-off and 1 air check valve	1/8"	SHC-V2
Smart healthy caps GL45, 3 outlets with shut-off and 1 air check valve	1/8"	SHC-V3
Smart healthy caps GL45, 4 outlets with shut-off and 1 air check valve	1/8"	SHC-V4

**For another diameter, specify it when ordering.*

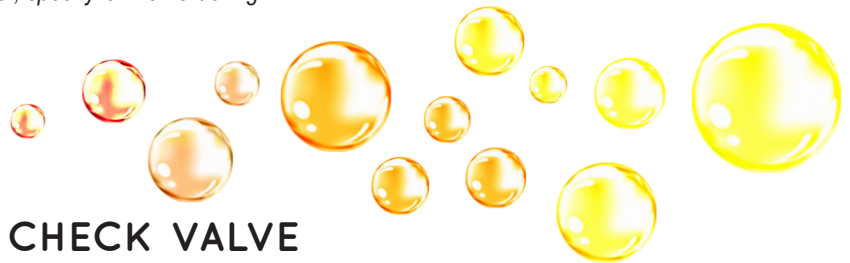

GROUND NECK WITH AIR CHECK VALVE

Smart Healthy Caps with ground neck 29/32 are made for ground-necked flasks. Smart Healthy Caps are delivered with their universal capillary connector (external diameter 1/8" to 1/16").



SHC-1-EM



SHC-2-EM



AD-45-EM**

****SHC-2 sold separately.**

SMART HEALTHY CAPS

GROUND NECK WITH AIR CHECK VALVE

DESCRIPTION	FOR TUBE (OD)*	REFERENCE
Smart healthy caps, ground neck (29/32 mm)	1 outlet (1/8"), 1 air check valve	SHC-1-EM
Smart healthy caps, ground neck (29/32 mm)	2 outlets (1/8"), 1 air check valve	SHC-2-EM
Smart healthy caps, ground neck (29/32 mm)	3 outlets (1/8"), 1 air check valve	SHC-3-EM
Smart healthy caps, ground neck (29/32 mm)	4 outlets (1/8"), 1 air check valve	SHC-4-EM

* For another diameter, precise it when you order it.



DISTRI SMART SAFE WITH A SMART HEALTHY CAP

DESCRIPTION	REFERENCE
Distri Smart Safe Adapter of 1 outlet (1/8" or 1/16") + 1 air check valve	SHC-1PV
Distri Smart Safe Adapter of 2 outlets (1/8" or 1/16") + 1 air check valve	SHC-2PV
Distri Smart Safe Adapter of 3 outlets (1/8" or 1/16") + 1 air check valve	SHC-3PV
Distri Smart Safe Adapter of 4 outlets (1/8" or 1/16") + 1 air check valve	SHC-4PV
Pipette 1 to 10 mL *	DIS 10
Pipette 2,5 to 25 mL *	DIS 25

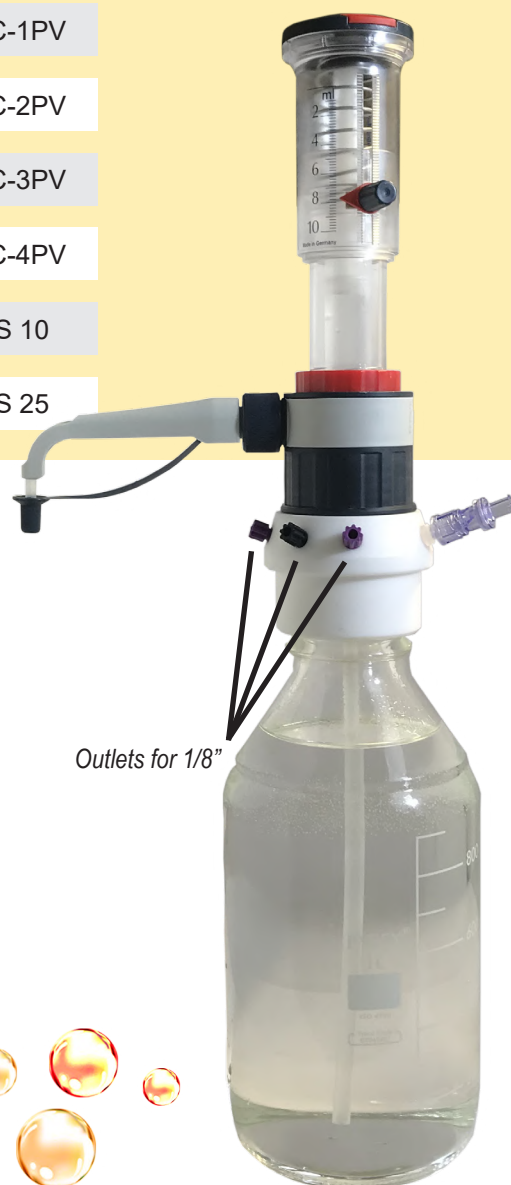

A.I.T. is introducing a new variable volume system for eluent distribution which can be directly attached to your HPLC solvent bottle. It provides with the same benefits as the Smart Healthy Caps but with this additional feature. The neck is compatible with the DURAN® GL45 bottles.

* To obtain the same configuration as the picture above, choose a Distri Smart Safe Adapter and a pipette.

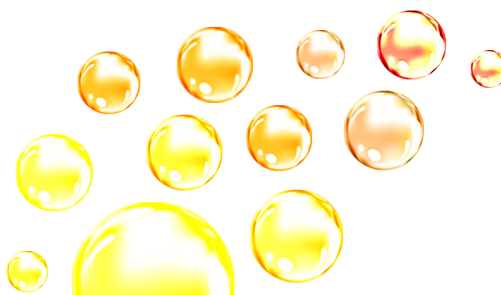

SMART HEALTHY CAPS

ANALYTICAL SYSTEM

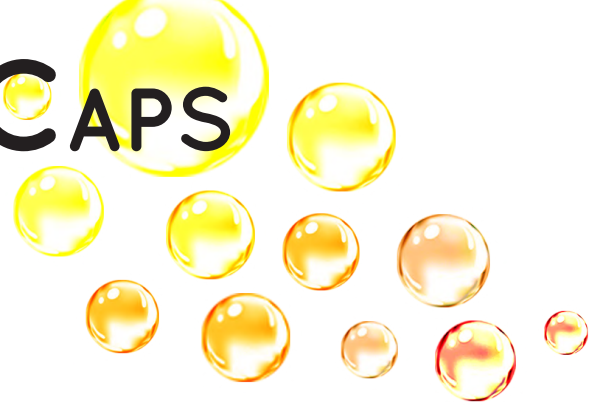

Smart Healthy Caps Septum offers you the possibility to introduce or withdraw a volume of solvent or reagent of your choice at any time.

DESCRIPTION	REFERENCE
Smart Healthy Caps GL45 1 septum*, 1 outlet (1/8" or 1/16") and 1 air check valve	SHC-1-SEPT
Smart Healthy Caps GL45 1 septum*, 2 outlets (1/8" or 1/16") and 1 air check valve	SHC-2-SEPT
Smart Healthy Caps GL45 1 septum*, 3 outlets (1/8" or 1/16") and 1 air check valve	SHC-3-SEPT



*The septum is delivered as standard, non-pierced

SHC-2-SEPT



SMART HEALTHY CAPS

PREPARATIVE SYSTEM

SMART HEALTHY CAPS FOR GL45 SCHOTT®
OR DURAN® TYPE

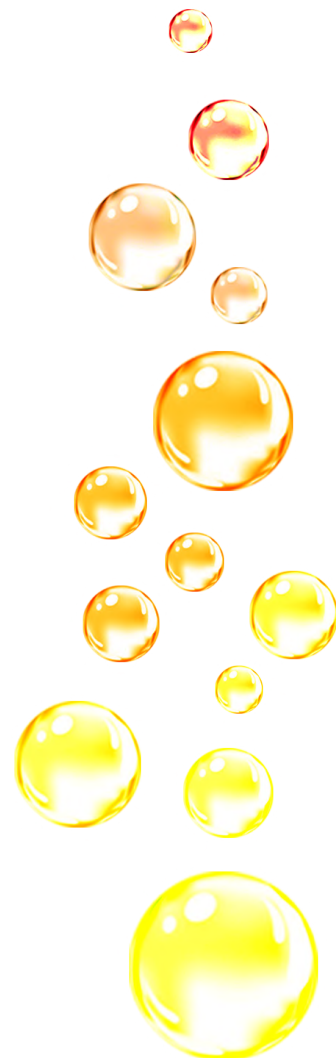

Warning : Change your air check valve **once a year.**

DESCRIPTION	REFERENCE
Smart Healthy Caps GL45 for preparative HPLC with 1 outlet (1/4") + 1 air check valve	SHC-P-A
Smart Healthy Caps GL45 for preparative HPLC with 2 outlets (1/4" and 1/8") + 1 air check valve	SHC-P-A-C
Smart Healthy Caps GL45 for preparative HPLC with 1 outlet (3/16") + 1 air check valve	SHC-P-B
Smart Healthy Caps GL45 for preparative HPLC with 2 outlets (3/16") + 1 air check valve	SHC-P-2B



SHC-P-A-C



SHC-P-A



SHC-P-B

**OTHER
CONFIGURATIONS
POSSIBLE ON
REQUEST!**

SMART HEALTHY CAPS

PREPARATIVE SYSTEM

SMART HEALTHY CAPS FOR DIN51/S55 AND DIN60/S60 THREADS

Specially adapted for large volumes of preparative HPLC eluents. The air check valve works with a flow rate from 100ml / min to 500ml / min.



DESCRIPTION *	REFERENCE
Smart Healthy Caps S55 for preparative HPLC with 1 outlet (1/4") + 1 air check valve	SHC55-P-A
Smart Healthy Caps S55 for preparative HPLC with 2 outlets (1/4" et 1/8") + 1 air check valve	SHC55-P-A-C
Smart Healthy Caps S55 for preparative HPLC with 1 outlet (3/16") + 1 air check valve	SHC55-P-B
Smart Healthy Caps S60 for preparative HPLC with 1 outlet (1/4") + 1 air check valve	SHC60-P-A
Smart Healthy Caps S60 for preparative HPLC with 2 outlets (1/4" et 1/8") + 1 air check valve	SHC60-P-A-C
Smart Healthy Caps S60 for preparative HPLC with 1 outlet (3/16") + 1 air check valve	SHC60-P-B

**also available with any type of thread (Nalgene, DIN90...)*



Create your own reference !

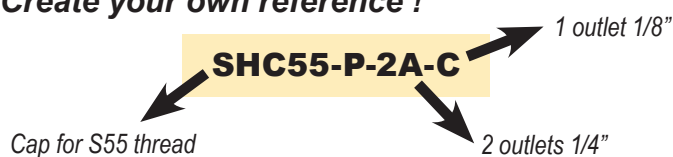

Outlets : A = 1/4", B = 3/16", C = 1/8", D = 5/16"

SMART HEALTHY CAPS

PREPARATIVE SYSTEM

SMART HEALTHY CAPS WITH FUNNEL FOR PREPARATIVE HPLC BOTTLE

This Smart Healthy Caps, equipped with a funnel with hinged lid, allows to pour the eluent into the bottle without having to unscrew the cap. It is equipped with an air check valve.



DESCRIPTION	THREAD	REFERENCE
Funnel with hinged lid for solvent reservoir with one outlet of 4 mm (3/16") and one air check valve	GL45	SHC45-FSP-B
	S55	SHC55-FSP-B
	S60	SHC60-FSP-B
	NALGENE® B53	SHCB53-FSP-B
	Metallic barrel	SHCBA-FSP-B
Funnel with hinged lid for solvent reservoir with one outlet of 6.4 mm (1/4") and one air check valve	GL45	SHC45-FSP-A
	S55	SHC55-FSP-A
	S60	SHC60-FSP-A
	NALGENE® B53	SHCB53-FSP-A
	Metallic barrel	SHCBA-FSP-A
Funnel with hinged lid for solvent reservoir with one outlet of 3.2 mm (1/8") and one air check valve	GL45	SHC45-FSP-C
	S55	SHC55-FSP-C
	S60	SHC60-FSP-C
	NALGENE® B53	SHCB53-FSP-C
	Metallic barrel	SHCBA-FSP-C

Create your own reference !

SHC55 - FSP - B

Thread type → Tube outer diameter

Outlets : A = 1/4", B = 3/16", C = 1/8"

SMART HEALTHY CAPS

ADAPTERS WITH MULTIPLE WAYS

MULTI-WAYS ADAPTER ALLOWING TO CONNECT A BOTTLE WITH A GL45 THREAD TO 2 & 4 GL45 SAFETY CAPS*

The multi-ways adapter allows several channels to be purged in the eluent bottle while remaining airtight.

BEFORE...

AFTER!

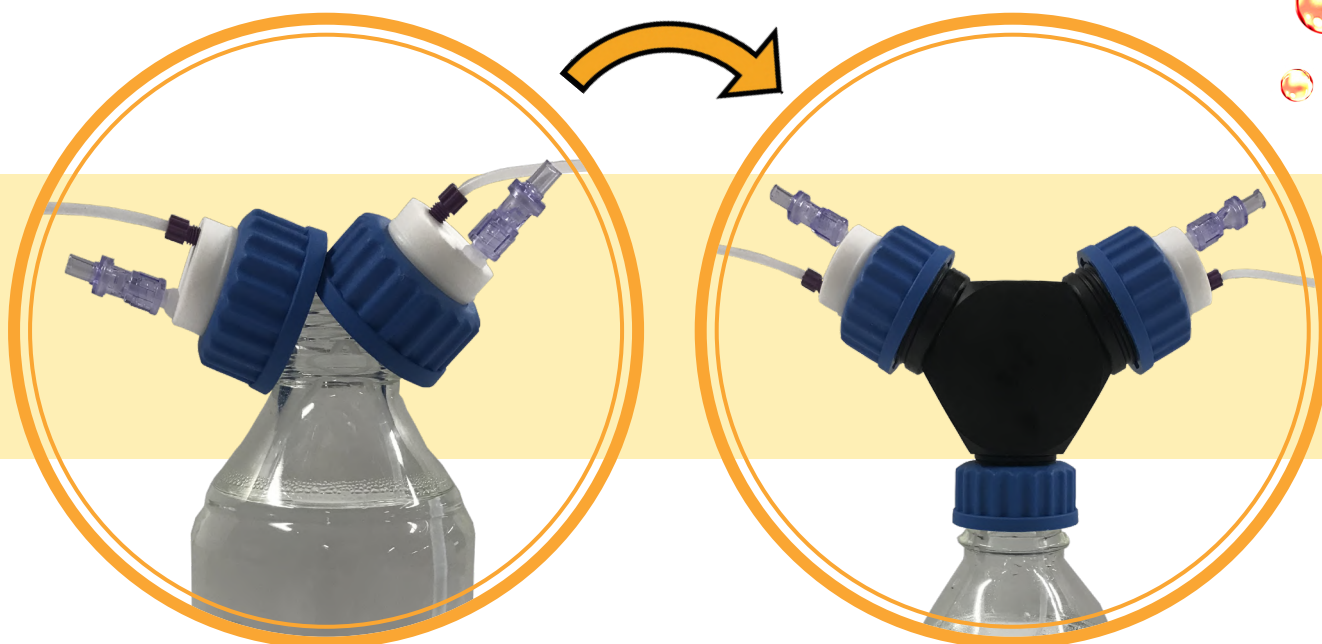

AD-2T-GL45
2 heads for bottle GL45



AD-4T-GL45
4 heads for bottle GL45



AD-4T-GL80-GL45
4 heads for bottle GL80

* Also available for other threads of bottles and cans

SMART HEALTHY CAPS

ADAPTERS

OPERATING PRINCIPLE

We can supply you with all types of adapters not described in the catalog.
Do not hesitate to ask us!



32 mm

GL32 bottle
Measures 32 mm for
external threads.



38 mm

GL38 bottle
Measures 38 mm for
external threads.



45 mm

GL45 bottle
Measures 45 mm for
external threads.

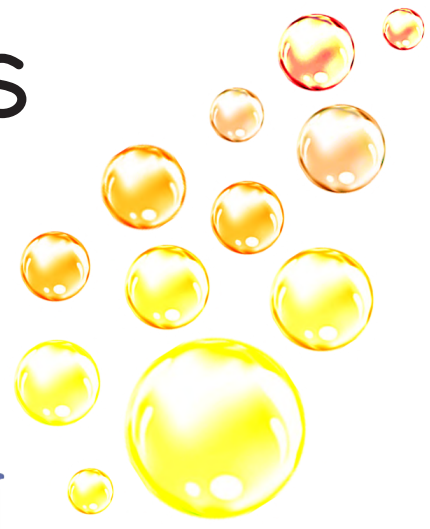

Smart Healthy Caps GL45

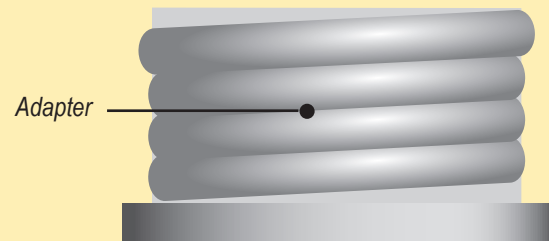

Adapter

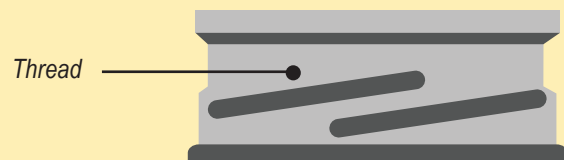

Thread

SMART HEALTHY CAPS

CLASSIC ADAPTERS

To connect a GL45 cap on a bottle with a different thread.

THREAD*	To**	MATERIAL	REFERENCE
GL40	GL45	PTFE	AD-40-45-T
GL40	GL45	PP	AD-40-45-P
GL32	GL45	PTFE	AD-32-45-T
GL32	GL45	PP	AD-32-45-P
GL38	GL45	PTFE	AD-38-45-T
GL38	GL45	PP	AD-38-45-P



AD-40-38-P



AD-38-45-T



AD-40-45-P

PTFE : Teflon.

PP : Polypropylene.

* Bottle thread

** Cap's Thread : Smart Healthy Caps.

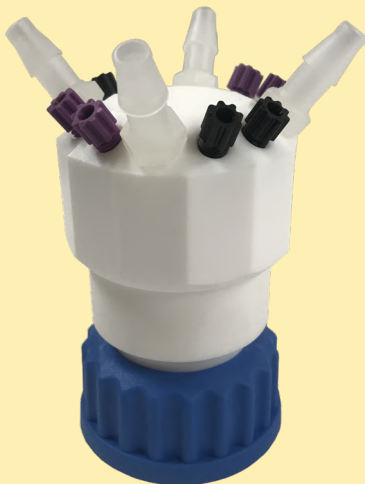

SPECIAL MANUFACTURING AT THE REQUEST OF ANY CAP OR ACCESSORY ACCORDING TO YOUR OWN SPECIFICATIONS : FROM A SINGLE TO NUMEROUS PIECES!

SMART HEALTHY CAPS

BOTTLES

DURAN® GL45 BOTTLE

A complete range of solvent bottles perfectly adapted for GL45 Smart Healthy Caps.

GL250-C



GL2000-C



GL500-C



GL1000-C



VOLUME (mL)	GLASS	REFERENCE
250	Clear	GL250-C
250	Amber	GL250-A
500	Clear	GL500-C
500	Amber	GL500-A
1000	Clear	GL1000-C
1000	Amber	GL1000-A
2000	Clear	GL2000-C
2000	Amber	GL2000-A
5000	Clear	GL5000-C
5000	Amber	GL5000-A

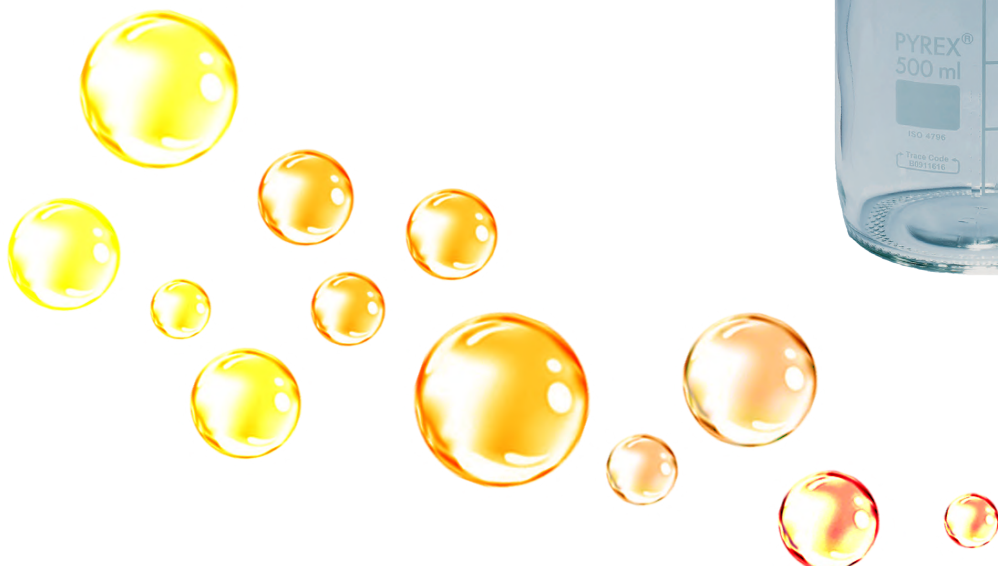

SMART HEALTHY CAPS

ACCESSORIES : AIR CHECK VALVES

All our Smart Healthy Caps are equipped with a standard air check valve.

For optimal use, it is recommended to **change the air check valve once a year!**

STANDARD AIR CHECK VALVE

For organo-aqueous eluents.

Weak and strong acidic eluents.

Non-amino basic eluents.

Polar & apolar eluents.

Maximum recommended flow: 100mL / min

REFERENCE	QTY
SHC-SV	1
SHC-SV10	10
SHC-SV50	50

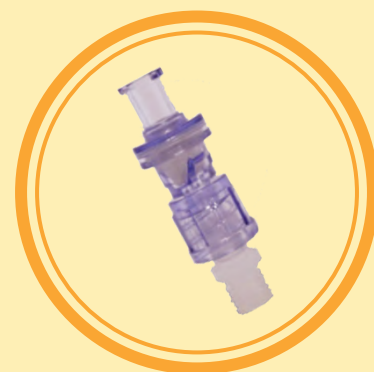

SHC-SV-PREP

AIR CHECK VALVE FOR PREPARATIVE HPLC

Same characteristics as the standard air check valve but for HPLC systems with very high flow rates (>100mL / min and <500mL / min).

AIR CHECK VALVE RESISTANT TO HIGH CONTENT OF AMINO BASES

Same characteristics as the standard air check valve, but essential for the use of eluents containing bases with high pKa (triethylamine) or high concentrations (ammonia).

REFERENCE	QTY
SHC-SV-AB	1
SHC-SV-AB10	10
SHC-SV-AB50	50



SMART HEALTHY CAPS

ACCESSORIES : UNIVERSAL CAPILLARY CONNECTORS

- Facilitates the connection of capillary tubes from 1 mm to 3,2 mm (1/8")
- The universal capillary connector replaces the entire fitting + ferrule 1/8" and 1/16"
- The universal capillary connector ensures excellent sealing

GUIDE FOR UNIVERSAL CAPILLARY CONNECTOR CHANGE:

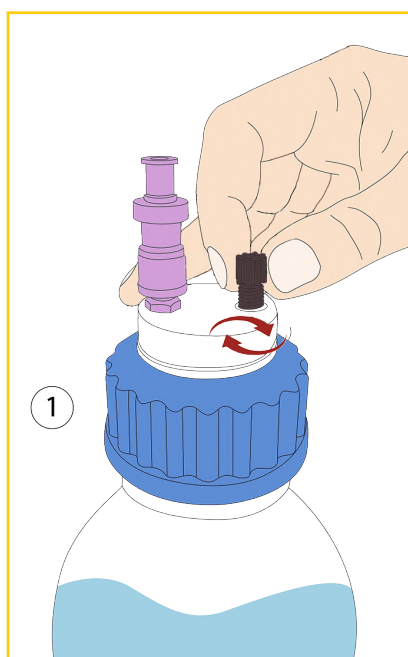

- Insert the universal capillary connector into its proper thread, without fully tightening it.

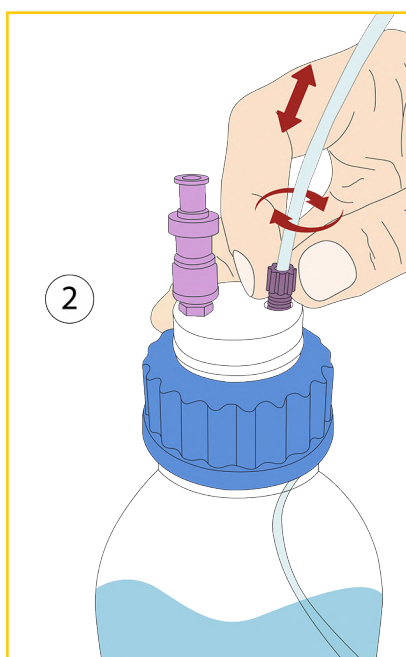

- Insert your tube into the universal capillary connector, adjust its length and then screw the fitting until the tube stops moving.

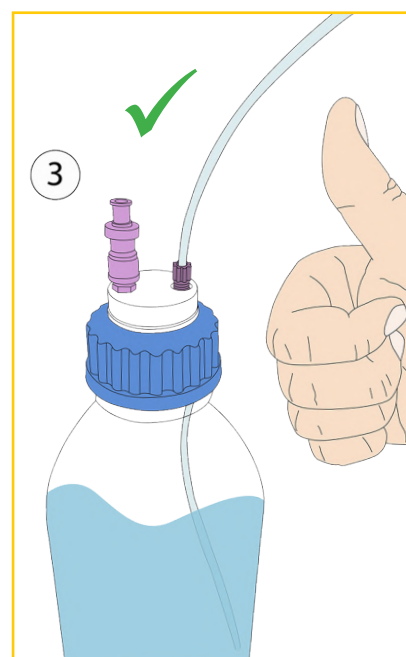

- Installation completed!

DESCRIPTION	FOR TUBE (OD)	COLOR	QTY/PK	REFERENCE
Universal capillary connector, Type I Black	for 1/16" to 1mm	Black	5	CC-ONE-1BL
Universal capillary connector, Type I Purple	for 1/16" to 1mm	Purple	5	CC-ONE-1V
Universal capillary connector, Type II Black	for 1/8" to 1/16"	Black	5	CC-ONE-2BL
Universal capillary connector, Type II Purple	for 1/8" to 1/16"	Purple	5	CC-ONE-2V



SMART HEALTHY CAPS



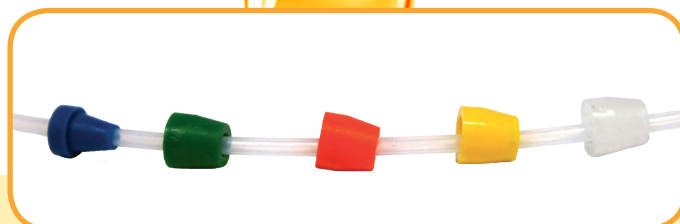

ACCESSORIES

NUTS AND FERRULES FOR 1/8" AND 1/16"

Ferrules 1/8", ref : F18. Flangefree fitting for ferrule 1/8" OD.
 Ferrules 1/16", ref : F16. Flangefree fitting for ferrule 1/16" OD.



* Please join to the reference the color you want.
 For example : R18-N for black nuts.

Red : R 
 Blue: B 
 Green: G 
 Purple: P 
 Black: N 

TUBE (OD)		REFERENCE NUTS	REFERENCE FERRULES
INCH	MILLIMETER	PER 10 UNITS *	PER 10 UNITS
1/4"	6,3 mm	R14	F14
3/16"	4 mm	R316	F316
1/8"	3,2 mm	R18	F18
	2,5 mm	R18	F25
1/16"	1,6 mm	R16	F16
	1,0 mm	R16	F10

BLIND PLUG, ALLOWING YOU TO CLOSE AN UNUSED OUTLET OF YOUR SMART HEALTHY CAPS

FOR	REFERENCE	QUANTITY
Vis 1/8"-1/16"	VP-F18	Par 10



SMART HEALTHY CAPS

PTFE TUBES

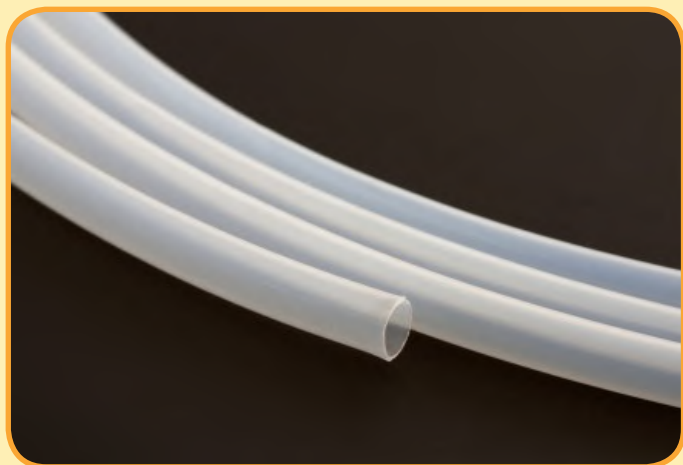

OD	ID	REFERENCE *	QUANTITY
1/4"	6,3 mm	TP14	1 meter
3/16"	3 mm	TP316	1 meter
1/8"	1,6 mm	TP18	1 meter
1/16"	1,0 mm	TP16	1 meter

TYGON™ TUBES

OD	ID	REFERENCE *	QUANTITY
9,5 mm	6,4 mm	TYG-64	1 meter
19,1 mm	12,7 mm	TYG-127	1 meter

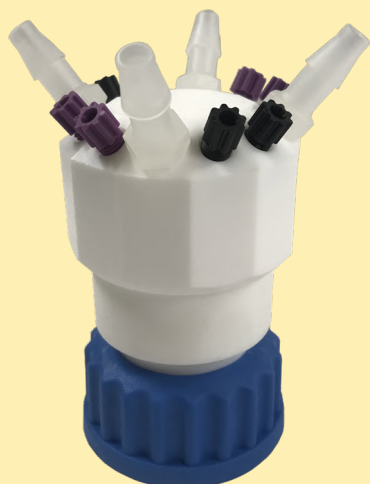
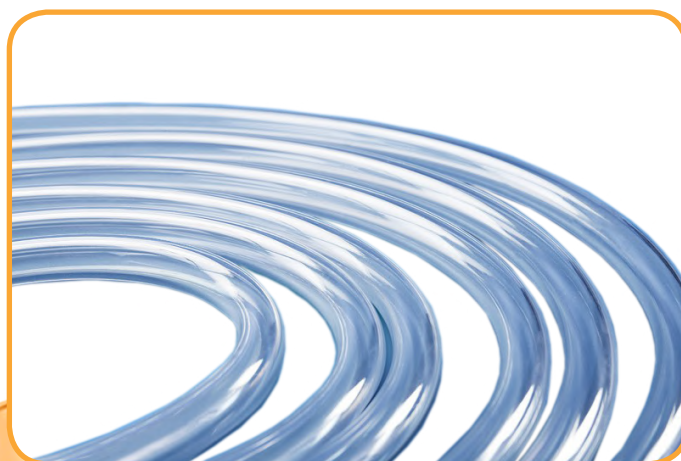

SPECIAL MANUFACTURING AT THE REQUEST OF ANY CAP OR ACCESSORY ACCORDING TO YOUR OWN SPECIFICATIONS: FROM A SINGLE TO NUMEROUS PIECES!

SMART WASTE CAPS

ACTIVATED CHARCOAL CARTRIDGE

ACTIVATED CHARCOAL CARTRIDGE FOR CANS FROM 2,5 TO 20 LITERS



* AD-VL

** AD-14-28

* Adapter to connect activated charcoal cartridge to Vaplock™ manifold

** Adapter to connect to thread 1/4" - 28 (like capillary fitting)

Each cartridge is delivered with a label on which you can write the commissioning date and the replacement date of your cartridge. The replacement date depends on the quantity of activated charcoal in the cartridge.

* For each charcoal filter cartridge order, a time monitoring is delivered if you ask for. Just add the letter T at the end of the reference.

DESCRIPTION	CHARCOAL QUANTITY	DURATION	REFERENCES	
			UNIT	PACK OF 3
Activated charcoal cartridge	25 gr	3 months	FC-25	FC-25-3
Activated charcoal cartridge	50 gr	6 months	FC-50	FC-50-3
Activated charcoal cartridge with a lid	50 gr	6 months	FC-50-C	FC-50-C-3
Activated charcoal cartridge	100 gr	12 months	FC-100	FC-100-3
Activated charcoal cartridge loaded with H ₂ SO ₄ for volatile base in waste eluants.	100 gr	6 to 12 months	FC-100-H2SO4	FC-100-H2SO4-3
Activated charcoal cartridge loaded with KOH for volatile acid in waste eluants.	100 gr	6 to 12 months	FC-100-KOH	FC-100-KOH-3

SMART WASTE CAPS

This activated carbon cartridge has been specially designed to trap the gas emissions at the analyzer output in LC-MS. The cartridge is studied to generate a low back pressure and thus prevent overheating of the activated carbon in contact with vapors from the LC-MS.



SMART WASTE CAPS FOR LC-MS

With an emplacement for an activated carbon cartridge and a tube inlet ID 12-15 mm (other diameter possible on request)

THREAD	REFERENCE
GL45	SW45-MS
SW55	SW55-MS
SW60	SW60-MS
Nalgene B53	SWB53-MS
Nalgene B83	SWB83-MS



ACTIVATED CHARCOAL CARTRIDGE FOR LC-MS

DESCRIPTION	CHARCOAL QUANTITY	DURATION	REFERENCE
Activated Charcoal Cartridge for LC-MS	50 gr	6 months	FC-50-MS

SMART WASTE CAPS

ACTIVATED CHARCOAL CARTRIDGE

ADAPTERS FOR ACTIVATED CHARCOAL CARTRIDGE

If you have a problem to place the can with the cartridge under the bench, we offer you 3 types of adapters which can be combined to solve all of you problems. You can see below few types of combinations. Other combinations are possible.

FC-D



FC-180



FC-90



DESCRIPTION	REFERENCE
Straight extension long piece	FC-D
90° Adapter for angled connection	FC-90
Double angled connection adapter (combination of 2 FC-90)	FC-180

FC-180



FC-180



FC-90



SMART WASTE CAPS

SPECIAL ADAPTERS* FOR JUSTRITE® CAN

* Allows to accept activated charcoal cartridge on JUSTRITE® can.



FC-AD-CPC



AD-CPC



FC-AD-JUST



AD-D-JUST

DESCRIPTION

REFERENCE

Adapter with 3 entries and a threaded barbed fitting for a direct CPC connection

AD-CPC

Adapter with 3 entries and a threaded barbed fitting for a connection on JUSTRITE® can

AD-D-JUST

Adapter with an activated charcoal cartridge location for JUSTRITE® container

FC-AD-JUST

Adapter with an activated charcoal cartridge location for CPC connection

FC-AD-CPC

SMART WASTE CAPS

GUIDE FOR INSTALLING A SMART WASTE CAPS

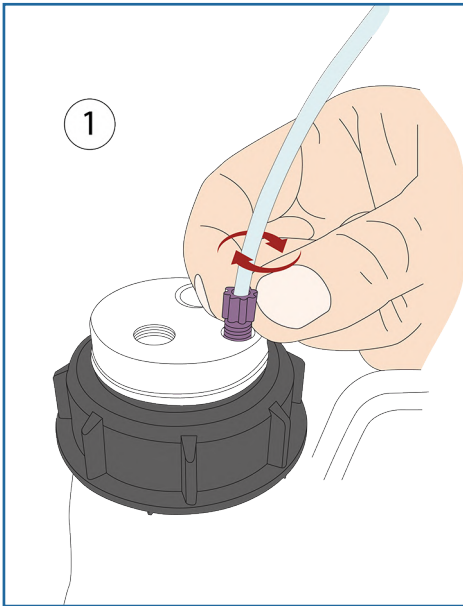

- Insert the universal capillary connector into its proper thread

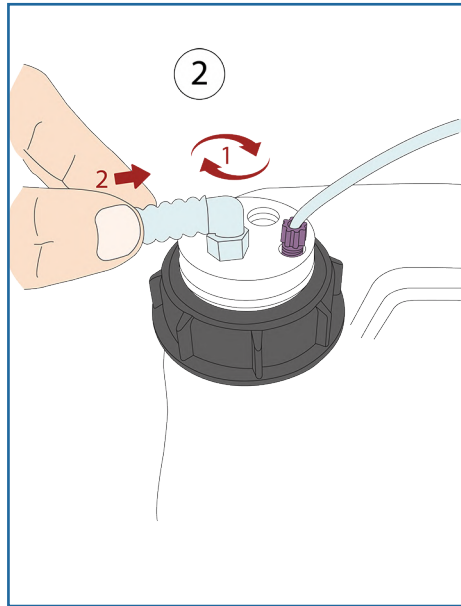

- Screw the threaded barbed fitting into its proper thread on your Smart Waste Cap. Connect your tube to the threaded barbed fitting

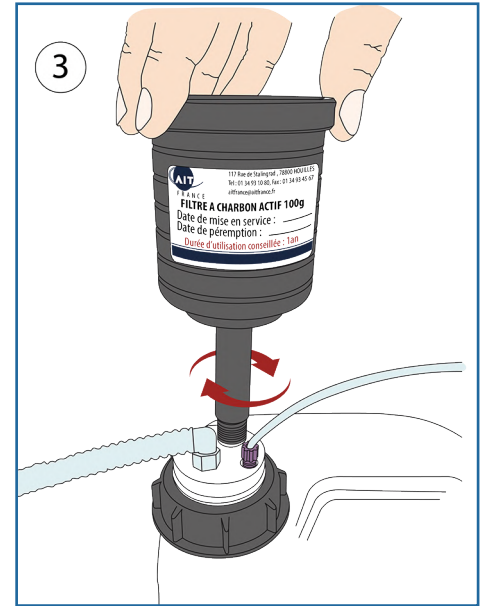

- Screw your activated charcoal cartridge into its proper thread on your Smart Waste Caps

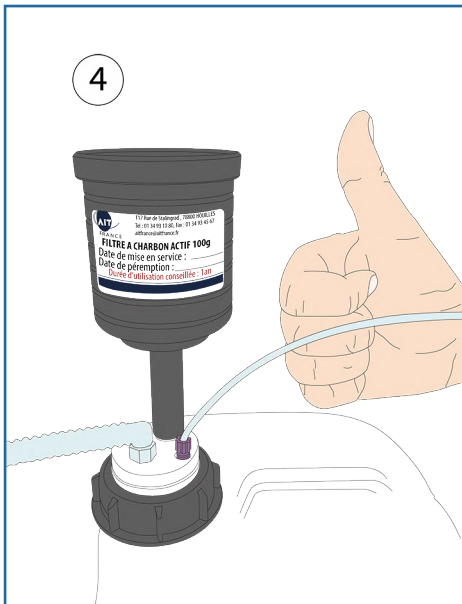

- Installation completed!



And do not forget to indicate the date of commissioning and the expiration date of your activated charcoal cartridge to anticipate its renewal!

SMART WASTE CAPS

SMART WASTE CAPS FOR DIN 51 / S55

CPS Smart Waste Caps for DIN 51/S55 with their universal capillary connector (external diameter 1/8" to 1/16") and threaded barbed fitting 6 to 9 mm.



SW55-4-C : 4 entries 1/8" and charcoal cartridge emplacement



SW55-1-C-1L : 1 entry 1/8", 1 threaded barbed fitting and charcoal cartridge emplacement



SW55-2-C-2L : 2 entries 1/8", 2 threaded barbed fittings and charcoal cartridge emplacement



SW55-1-C-3L : 1 entry 1/8", 3 threaded barbed fittings and charcoal cartridge emplacement

If you can't find the reference you want, then, create your own Smart Waste Cap even just for one item, without further cost.

Create your own reference !

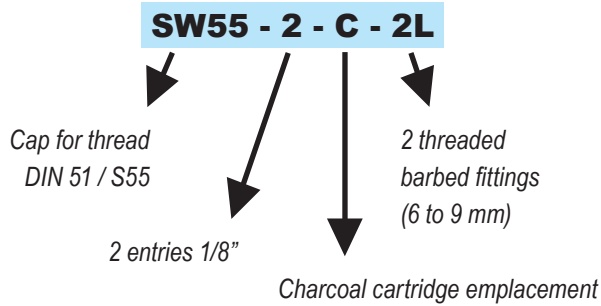

SW55-4-C-1L : 4 entries 1/8", a charcoal cartridge emplacement and 1 threaded barbed fitting



SW55-5-C : 4 entries 1/8" and a charcoal cartridge emplacement



SW55-3-C-2L : 3 entries 1/8", a charcoal cartridge emplacement and 2 threaded barbed fittings



SW55-3-C-3L : 3 entries 1/8", a charcoal cartridge emplacement and 3 threaded barbed fittings

SMART WASTE CAPS

SMART WASTE CAPS THREADS

SMART WASTE CAPS FOR GL45

CPS Smart Waste Caps for GL45 with their universal capillary connector (outer diameter 1/8" to 1/16") and threaded barbed fitting.



SW45-2-C : 2 entries 1/8" and charcoal cartridge emplacement



SW45-5-C : 5 entries 1/8" and charcoal cartridge emplacement



SW45-4-C-1L : 4 entries 1/8", 1 threaded barbed fitting and charcoal cartridge emplacement



SW45-1-C-2L : 1 entry 1/8", 2 threaded barbed fittings and charcoal cartridge emplacement

If you can't find the reference you want, then, create your own Smart Waste cap even just for one item, without further cost.

Create your own reference !

SW45 - 2 - C - 2L

Cap for thread
GL45

2 entries 1/8"

2 threaded
barbed fittings
(6 to 9 mm)

Charcoal cartridge emplacement



SW45-C-2L : a charcoal cartridge emplacement and 2 threaded barbed fittings



SW45-1-C-1L : 1 entry 1/8", a charcoal cartridge emplacement and 1 threaded barbed fitting



SW45-2-C-2L : 2 entries 1/8", a charcoal cartridge emplacement and 2 threaded barbed fittings



SW45-C-3L : a charcoal cartridge emplacement and 3 threaded barbed fittings

SMART WASTE CAPS

SMART WASTE CAPS THREADS

SMART WASTE CAPS BURKLE DIN50

Smart Waste Caps for space-saving cans S50 equipped with their universal capillary connector (outer diameter 1/8" to 1/16") and threaded barbed fitting 6 to 9 mm.



SWB-1-C-1L : 1 entry 1/8", 1 threaded barbed fitting and charcoal cartridge emplacement



SWB-3-C : 3 entries 1/8" and charcoal cartridge emplacement



SWB-1-C-3L : 1 entry 1/8", 3 threaded barbed fittings and charcoal cartridge emplacement



SWB-4-C-1L : 4 entries 1/8", 1 threaded barbed fitting and charcoal cartridge emplacement

If you can't find the reference you want, then, create your own Smart Waste cap even just for one item, without further cost.

Create your own reference !

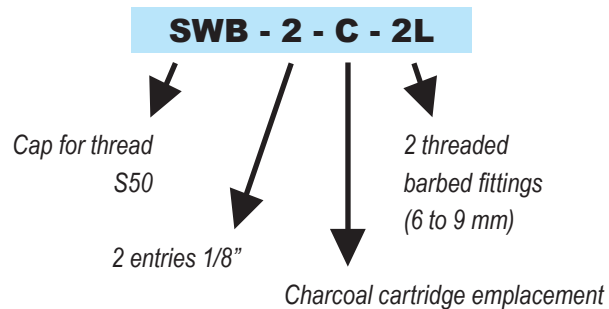

SWB-5-C : 5 entries 1/8" and charcoal cartridge emplacement



SWB-2-C-1L : 2 entries 1/8", 1 threaded barbed fitting and charcoal cartridge emplacement



Space saving can (5 Liters)
Ref : BS-GP

SMART WASTE CAPS

SMART WASTE CAPS THREADS

SMART WASTE CAPS FOR DIN 60 / S61

CPS Smart Waste Caps for DIN 60/S61 with their universal capillary connector (outer diameter 1/8" to 1/16") and threaded barbed fitting 6 to 9 mm.



SW60-2-C : 2 entries 1/8" and charcoal cartridge emplacement



SW60-2-C-1L : 2 entries 1/8", 1 threaded barbed fitting and charcoal cartridge emplacement



SW60-5-C-1L : 5 entries 1/8", 1 threaded barbed fitting and charcoal cartridge emplacement



SW60-1-C-4L : 1 entry 1/8", 4 threaded barbed fittings and charcoal cartridge emplacement

If you can't find the reference you want, then, create your own Smart Waste cap even just for one item, without further cost.

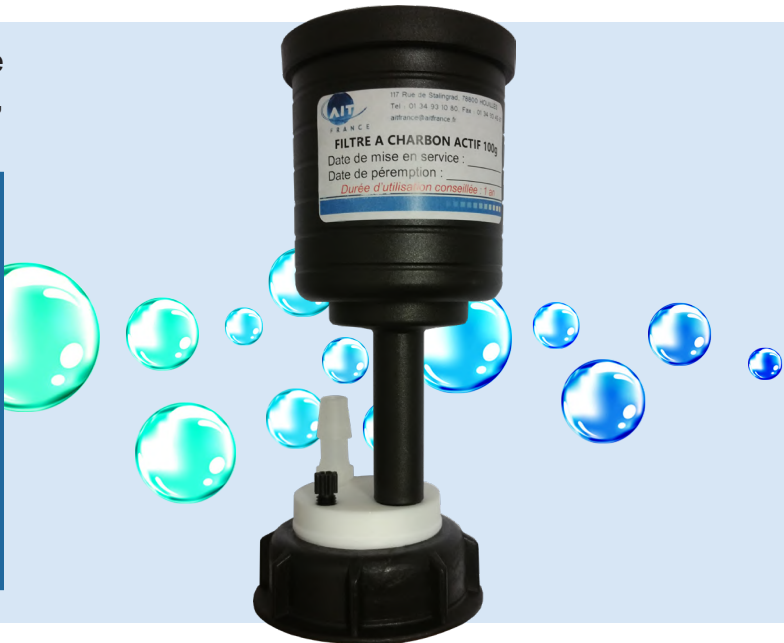
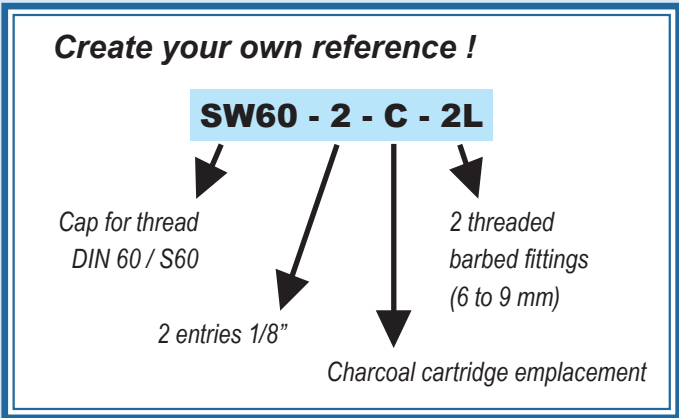

SW60-1-C-1L : 1 entry 1/8", a charcoal cartridge emplacement and 1 threaded barbed fitting



SW60-6-C : 6 entries 1/8" and a charcoal cartridge emplacement



SW60-2-C-4L : 2 entries 1/8", a charcoal cartridge emplacement and 4 threaded barbed fittings



SW60-C-1L : a charcoal cartridge emplacement and 1 threaded barbed fitting

SMART WASTE CAPS

SMART WASTE CAPS THREADS

SMART WASTE CAPS FOR DIN 90 / S90

CPS Smart Waste Caps for DIN 90/S90 with their universal capillary connector (outer diameter 1/8" to 1/16") and threaded barbed fitting 6 to 9 mm.



SW90-1-C-2L : 1 entry 1/8", 2 threaded barbed fittings and charcoal cartridge emplacement



SW90-4-C-4L : 4 entries 1/8", 4 threaded barbed fittings and charcoal cartridge emplacement



SW90-3-C-2L : 3 entries 1/8", 2 threaded barbed fittings and charcoal cartridge emplacement



SW90-4-C-1L : 4 entries 1/8", 1 threaded barbed fitting and charcoal cartridge emplacement

If you can't find the reference you want, then, create your own Smart Waste cap even just for one item, without further cost.

Create your own reference !

SW90 - 2 - C - 2L

Cap for thread
DIN 90 / S90

2 entries 1/8"

Charcoal cartridge emplacement

2 threaded
barbed fittings
(6 to 9 mm)



SW90-C-2L : 2 threaded barbed fittings and charcoal cartridge emplacement



SW90-C-5L : 5 threaded barbed fittings and charcoal cartridge emplacement



SMART WASTE CAPS

SMART WASTE CAPS THREADS

SMART WASTE CAPS FOR NALGENE'S® BOTTLES

CPS Smart Waste Caps for NALGENE's® bottles with their universal capillary connector (outer diameter 1/8" to 1/16") and threaded barbed fitting 6 to 9 mm.



SWB83-C-1L

THREAD REFERENCE

B53	SWB53-C-1L
B83	SWB83-C-1L

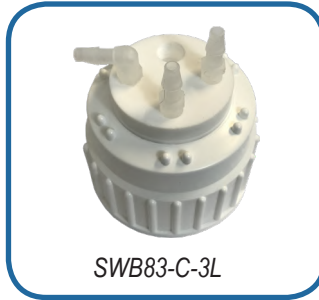

SWB83-C-3L

THREAD REFERENCE

B53	SWB53-C-3L
B83	SWB83-C-3L

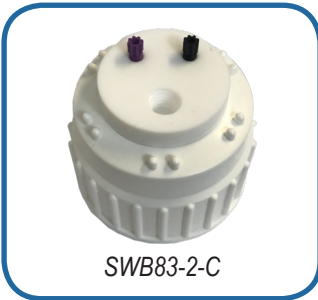

SWB83-2-C

THREAD REFERENCE

B53	SWB53-2-C
B83	SWB83-2-C



SWB83-4-C-1L

THREAD REFERENCE

B53	SWB53-4-C-1L
B83	SWB83-4-C-1L



If you can't find the reference you want, then, create your own Smart Waste Cap even just for one item, without further cost.

Create your own reference !

SWB53 - 2 - C - 2L

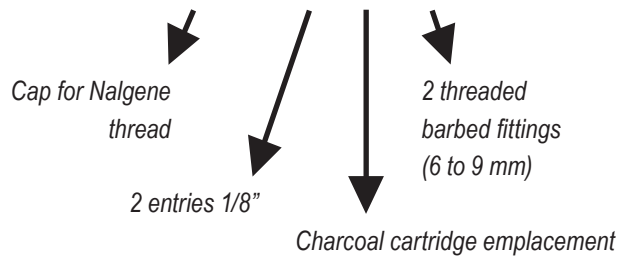

SMART WASTE CAPS

SMART WASTE CAPS THREADS

LEVEL INDICATOR

Thanks to the level indicator and its integrated floater, you can check immediately the can level.

The level indicator is absolutely necessary for all the opaque cans and the metallic barrel. We can also equipped the level indicator with fittings 1/8" or 1/16" and threaded barbed fitting 6 to 9 mm.

How it works ?

The level indicator is an option. So you can add it to the Smart Waste Caps reference that you want to equip.

For example, you want to equip the Smart Waste Cap following : SW45-2-C-1L with a level indicator. It becomes :

SW45-2-C-1L-LI

Please do not hesitate to contact us with any questions you may have.

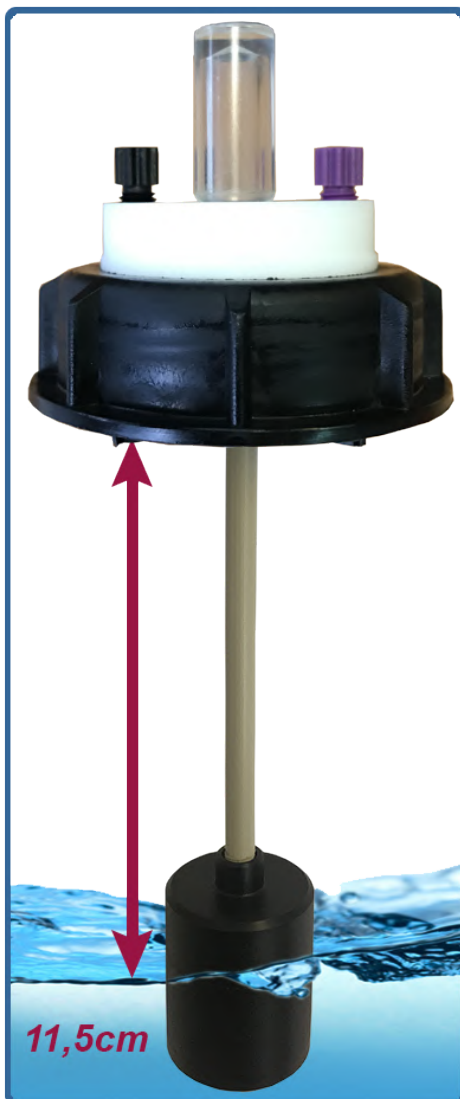

SMART WASTE CAPS

SPECIAL ADAPTERS

These 2 elements are easily fixed via their screw system and can go through the lab bench or be at the edge of the lab bench.

MULTI-MOL-8-2L

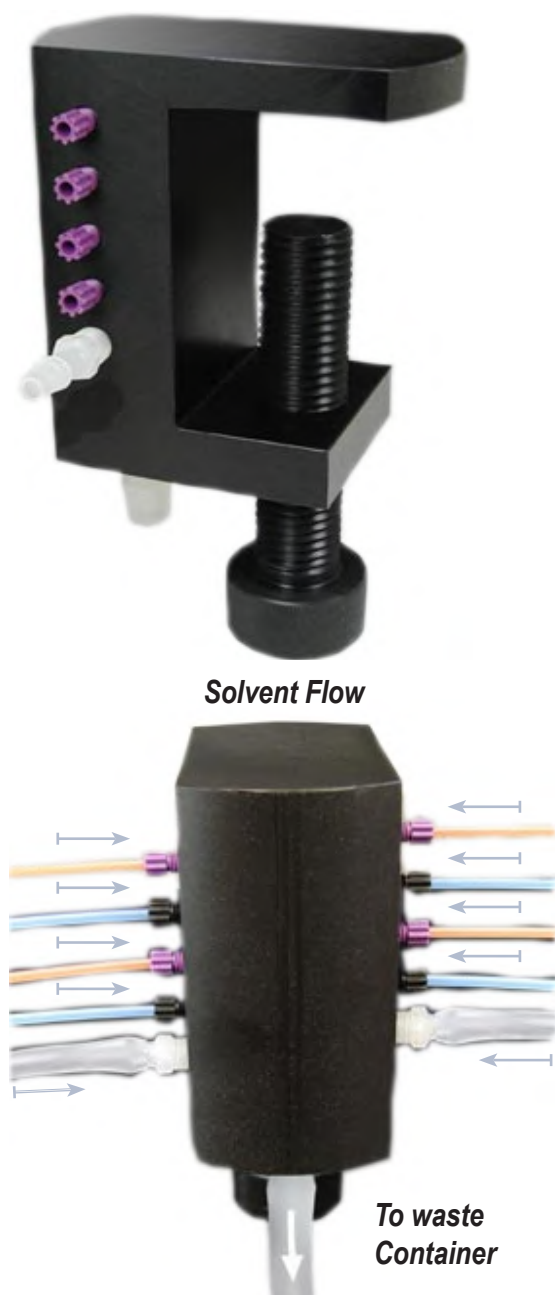

Multi-inlet system, 8 1/8" entries and 2 entries for tubes Tygon, with an outlet to a can under the lab bench (11 to 13mm in standard). The number of entries and their diameter is adjustable.

AD45-PAIL-1L



Through-hole adapter for SW45 or SW55 caps with 1 outlet for threaded barbed fitting (6 to 9mm in standard)

Create your own reference !

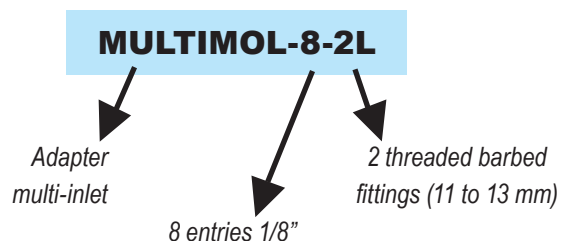

SMART WASTE CAPS

ADAPTERS

ALL TYPES OF ADAPTERS ARE POSSIBLE

UNLIMITED COMBINATIONS! (AS FAR AS POSSIBLE)



45 mm

GL45 bottle
Measures 45 mm for external thread.



48 mm

S55 can
Measures 48 mm for external thread.



53 mm

S60 can
Measures 53 mm for external thread.



SW45-C-1L

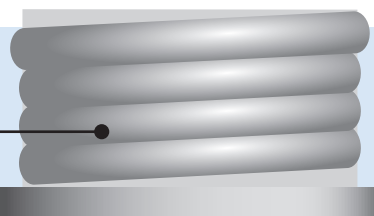

Adapter

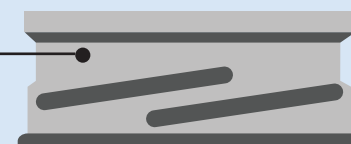

Thread

SMART WASTE CAPS

ADAPTERS

PP OR PTFE ADAPTERS FOR CANS EQUIPPED WITH A SMART WASTE CAPS

* PP : Polypropylene.

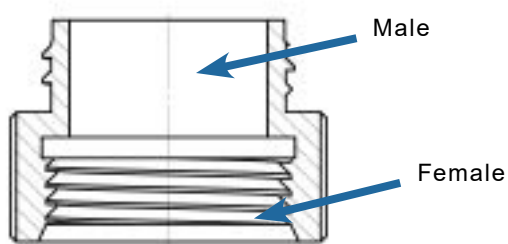
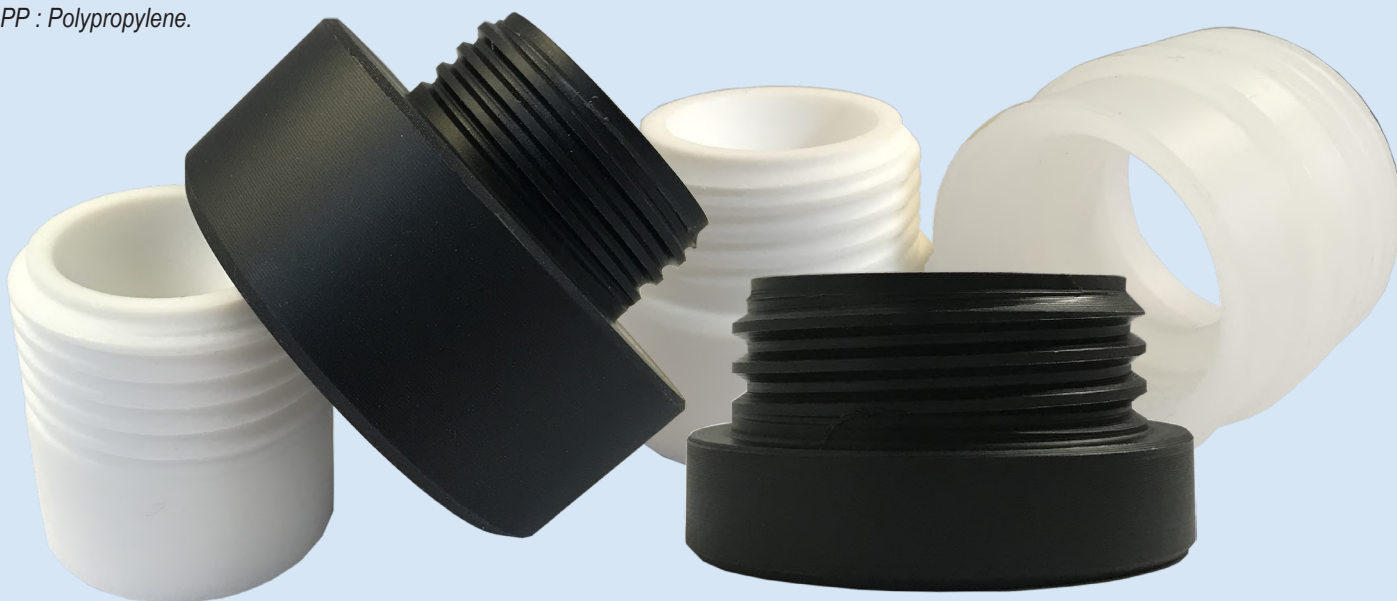

THREAD A* (FEMALE)	THREAD B** (MALE)	REFERENCE***
GL45	GL32	AD-45-32-P
GL40	GL32	AD-40-32-P
GL45	GL38	AD-45-38-P
GL40	GL38	AD-40-38-P
GL40	GL45	AD-40-45-P
GL45	S55	AD-45-55-P
S55	S60	AD-55-60-P
S55	GL45	AD-55-45-P
S60	S55	AD-60-55-P

Create your own adapter!

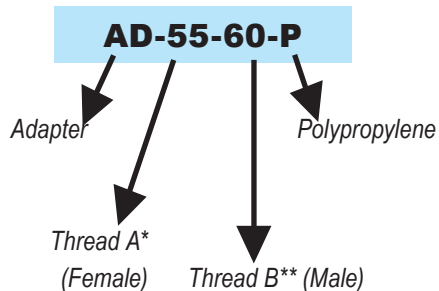

*A = can thread

**B = Smart Waste Caps thread

***also available in Teflon: for this, replace "P" with "T" in the reference of the desired product

SMART WASTE CAPS

ACCESSORIES : UNIVERSAL CAPILLARY CONNECTORS

- Facilitates the connection of capillary tubes from 1 mm to 3,2 mm (1/8")
- The universal capillary connector replaces the entire nut + ferrule 1/8" and 1/16"
- The universal capillary connector ensures excellent sealing

GUIDE TO CHANGE A UNIVERSAL CAPILLARY CONNECTOR :

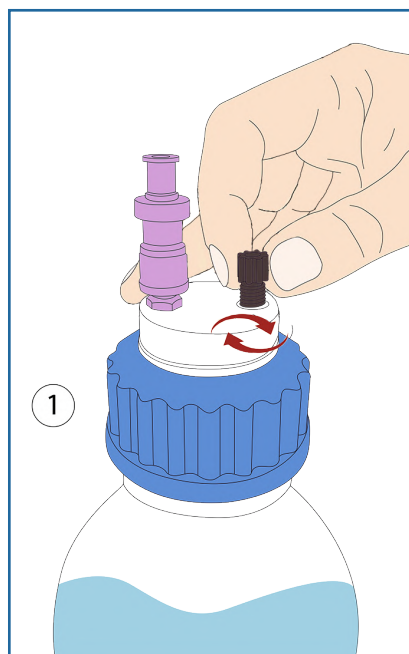

1
• Insert the universal capillary connector into its proper thread, without fully tightening it.

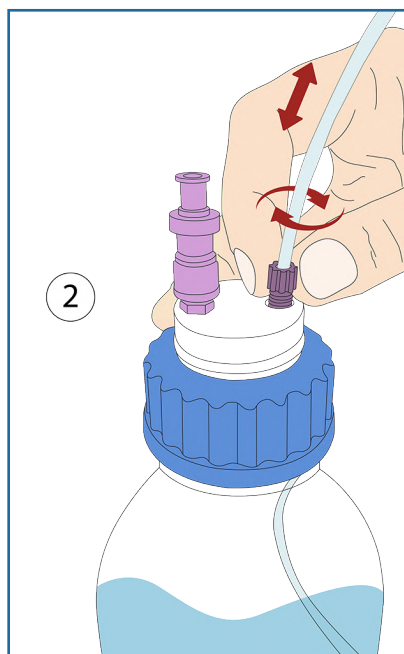

2
• Insert your tube into the universal capillary connector, adjust its length and then screw the fitting until the tube stops moving.

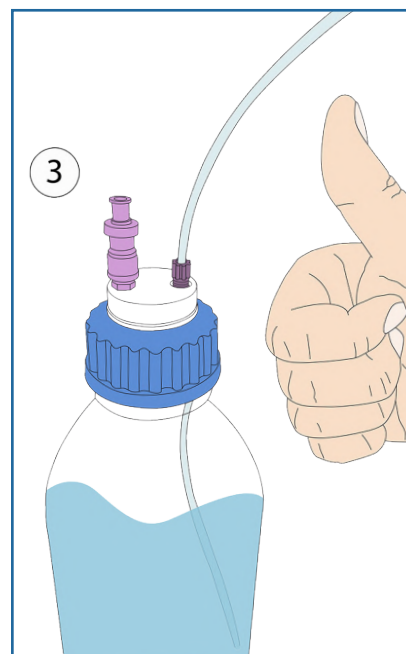

3
• Installation completed!

DESCRIPTION	FOR TUBES (OD)	COLOR	QTY/PK	REFERENCE
Universal capillary connector Type I Black	of 1/16" to 1mm	Black	5	CC-ONE-1BL
Universal capillary connector Type I Violet	of 1/16" to 1mm	Purple	5	CC-ONE-1V
Universal capillary connector Type II Black	of 1/8" to 1/16"	Black	5	CC-ONE-2BL
Universal capillary connector Type II Violet	of 1/8" to 1/16"	Purple	5	CC-ONE-2V



SMART WASTE CAPS

HOW TO KNOW THE THREAD OF YOUR CAP ?

SmartCaps are available for a wide range of threads. The table below will help you to know which thread you are using. We can adapt our SmartCaps to any kind of threads.



* G = Glass

** P = Plastic

Thread	ID Cap	OD Cap	OD container	ID container	Characteristics
GL 28	26.00	27.50	28.00	19.60	Chromsystem, Recipe, 500ml buffer by Sigma
GL 32 (G*)	29.50	31.50	31.50	16.80	For Duran's containers
GL 32 (P**)	29.60	32.60	32.20	18.20	-
GL 38 (G*)	35.50	37.00	37.50	25.70	For Wheaton's and Nalgene's containers
GL 38 (P**)	-	-	-	30.60	4l BDH bottle, Fulltime Reagents
GL 38 (short)	34.00	38.20	37.80	22.20	2.5l canister by Recipe, 1l Biosolve, 10l Fresenius Kabi
38-430	35.30	37.60	37.10	27.40	Wheaton, Nalgene square-cut 500ml plastic bottle
GL40 / S 40(G*)	38.00	40.00	40.00	26.2/27	For Merck's containers
GL40 / S 40(P*)	-	-	40.60	29.30	For Merck's and Metrohm's containers
S 41 / S 42(P*)	39.00	41.00	41.60	32.60	Number DIN42 is often in the cover, Polimoon
S 41 / S 42(G*)	39.00	41.60	42.00	32.10	-
GL 45 (G*)	41.50	45.00	44.50	29.50	Established thread of laboratory bottles
GL 45 (P*)	41.50	42.50	44.50	34.70	-
S 50	45.50	51.50	50.00	40.60	Space-saving canister
S 51	45.50	50.00	48.00	40.70	Nearly identical to S 50, number DIN50 is often in the cover
B 53	50.50	54.50	53.50	39.20	For Nalgene's and Polimoon's containers
S 55	50.50	55.00	53.50	43.30	The number 51/DIN 51/HP 51 is often in the cover
S 60 / S 61	55.50	61.00	59.00	48.20	Number 61 is often in the cover, Mauser 13, RPC containers
B 63	58.50	63.00	62.00	37.10	For Nalgene's containers
S 65	62.00	65.50	64.50	50.20	For Kautex's containers (round canister)
S 70 / S 71	66.00	71.50	70.00	59.40	The number 71 is often in the cover, Rieke 70mm
GLS 80	78.00	83.00	80.00	64.00	Established wide neck opening bottle
B83	83.00	90.00	88.00	65.30	For containers of the brands Kautex and Carboy 80mm
S90	85.00	90.50	88.00	78.50	The number D90 is often in the cover

SMART WASTE CAPS

STARTER KIT SMART WASTE CAPS

DESCRIPTION	REFERENCE
1x 5L space-saving can, 1x SmartWasteCaps S50 (2x entries 1/8", 1x exhaust filter emplacement & 2x threaded barbed fittings), 1x exhaust filter, 1x plug* for barbed fitting & 1x plug* for 1/8" nut	KIT-SW50
1x 5L can, 1x SmartWasteCaps S45 (2x entries 1/8", 1x exhaust filter emplacement & 2x threaded barbed fittings), 1x exhaust filter, 1x plug* for barbed fitting & 1x plug* for 1/8" nut	KIT-SW45
1x 10L can, 1x SmartWasteCaps S55 (2x entries 1/8", 1x exhaust filter emplacement & 2x threaded barbed fittings), 1x exhaust filter, 1x plug* for barbed fitting & 1x plug* for 1/8" nut	KIT-SW55
1x 20L can, 1x SmartWasteCaps S60 (2x entries 1/8", 1x exhaust filter emplacement & 2x threaded barbed fittings), 1x exhaust filter, 1x plug* for barbed fitting & 1x plug* for 1/8" nut	KIT-SW60



* Blind plugs for capillary entrie and threaded barbed fitting

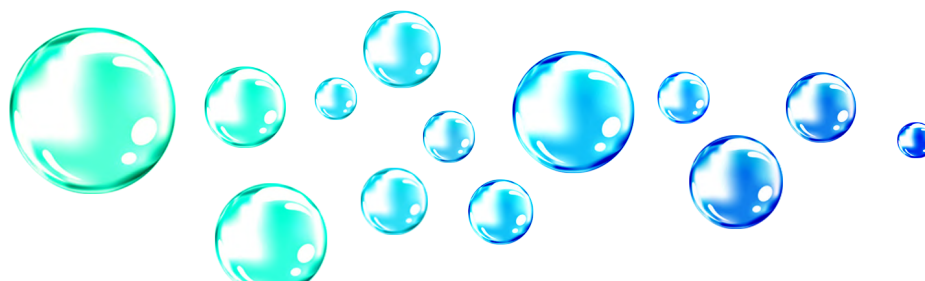

SMART WASTE CAPS

ACCESSORIES : *THREADED BARBED FITTINGS*

GUIDE FOR THREADED BARBED FITTING CHANGE :

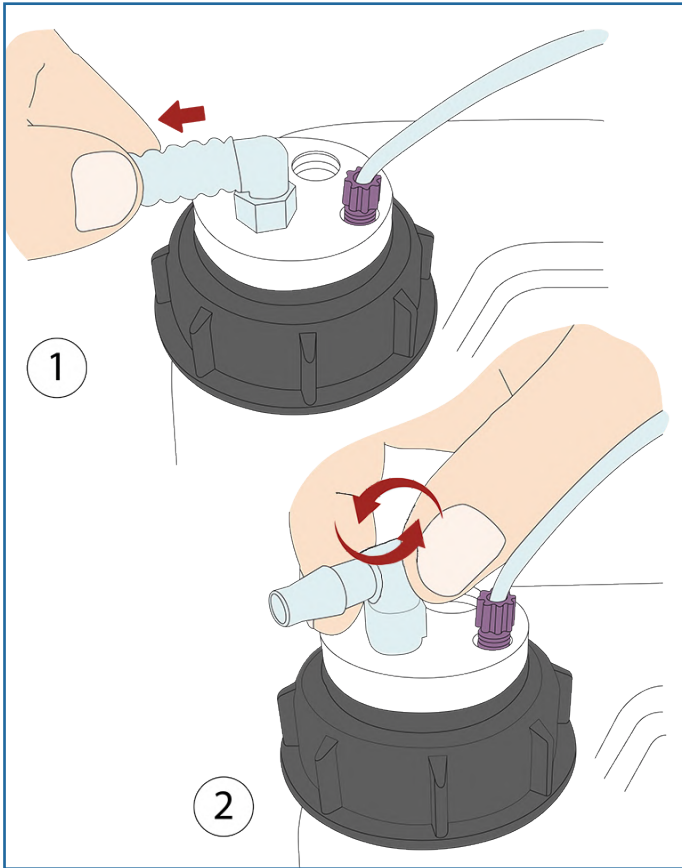

Remove the tube from the threaded barbed fitting to change, and then unscrew the threaded barbed fitting.



Screw the new threaded barbed fitting and insert your new tube. Your new connection is ready!

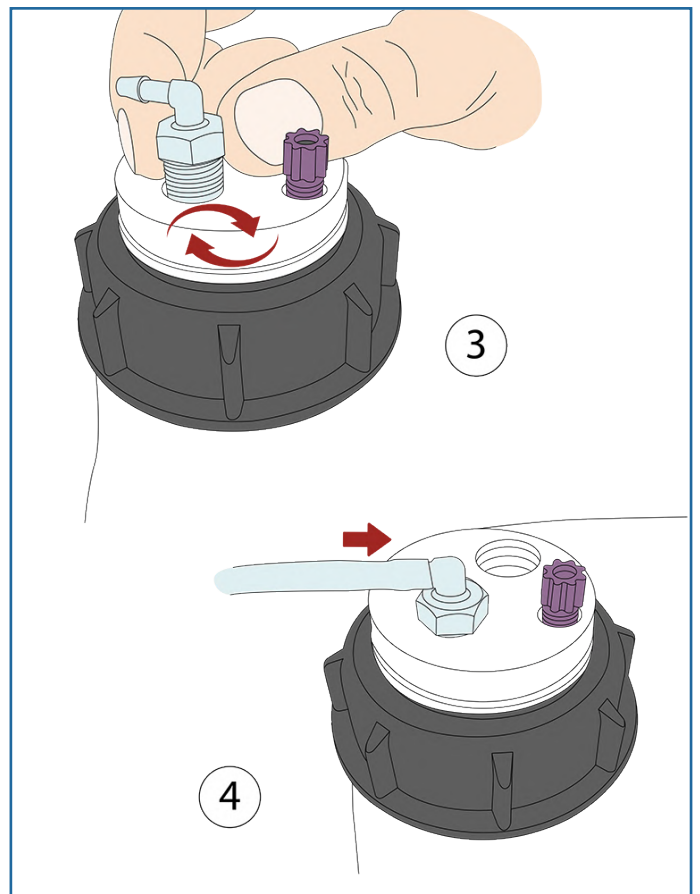

3

4

SMART WASTE CAPS

ACCESSORIES : THREADED BARBED FITTINGS*



*The illustrations of the products are in CAD and are not contractual.
The threaded barbed fittings are made of translucent PP.

STRAIGHT THREADED BARBED FITTING / PER UNIT

DESCRIPTION	TUBE DIAMETER (ID)	REFERENCE
Straight threaded barbed fitting	3 to 4 mm	RD-34
Straight threaded barbed fitting	5 to 6 mm	RD-56
Straight threaded barbed fitting	6 to 9 mm	RD-69
Straight threaded barbed fitting	9 to 11 mm	RD-911



ANGLED THREADED BARBED FITTING / PER UNIT

DESCRIPTION	TUBE DIAMETER (ID)	REFERENCE
Angled threaded barbed fitting	3 to 4 mm	RC-34
Angled threaded barbed fitting	5 to 6 mm	RC-56
Angled threaded barbed fitting	6 to 9 mm	RC-69
Angled threaded barbed fitting	9 to 11mm	RC-911



DOUBLE ANGLED THREADED BARBED FITTING / PER UNIT

DESCRIPTION	ID	REFERENCE
Double angled threaded barbed fitting	5 to 6 mm	RCY-56
Double angled threaded barbed fitting	6 to 9 mm	RCY-69

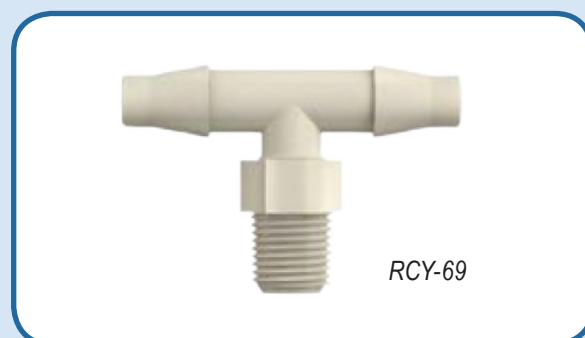

SMART WASTE CAPS

ACCESSORIES : CONNECTORS AND ADAPTERS

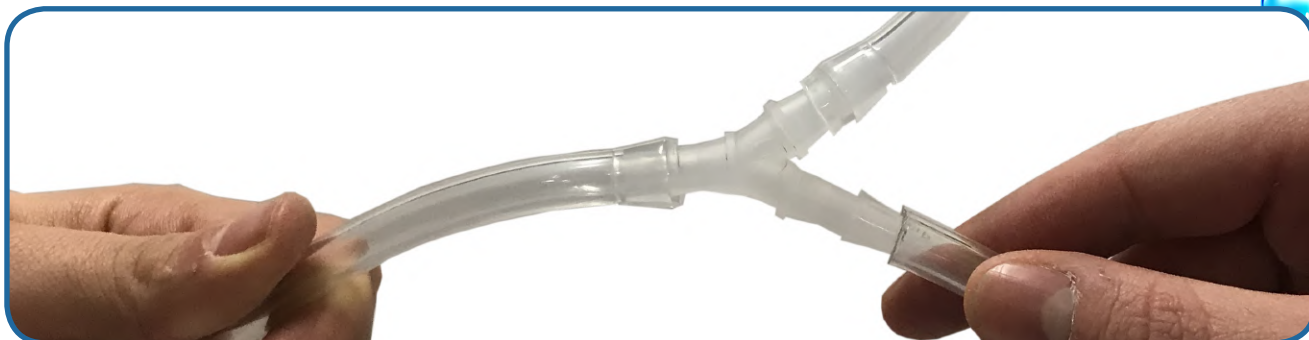

Y CONNECTORS, PER UNIT

DESCRIPTION	TUBE ID	REFERENCE
Y-Connector 3 mm	3 mm	Y-3
Y-Connector 5 mm	5 mm	Y-5
Y-Connector 7 mm	7 mm	Y-7
Y-Connector 9 mm	9 mm	Y-9
Y-Connector 11 mm	11 mm	Y-11

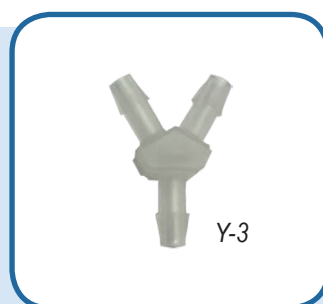

CONICAL REDUCERS AND ADAPTERS

FOR DIFFERENT SIZES OF TUBES

INLET DIAMETER	OULET DIAMETER	REFERENCE
4,2 - 8 mm	4,2 - 8 mm	CR-1
10,5 - 16 mm	6,5 - 12 mm	CR-3
11 - 15 mm	7 - 12 mm	CR-6

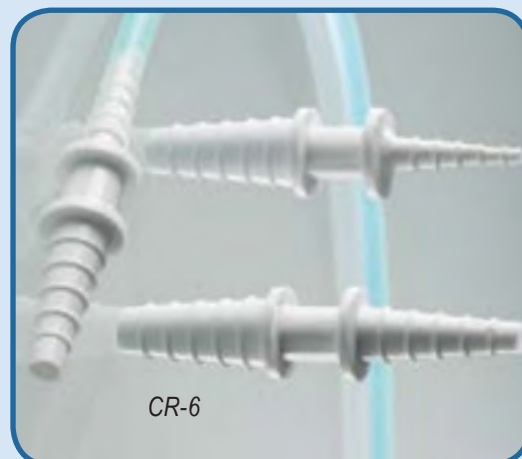

SMART WASTE CAPS

ACCESSORIES : TUBES AND BLIND PLUGS

PTFE TUBES

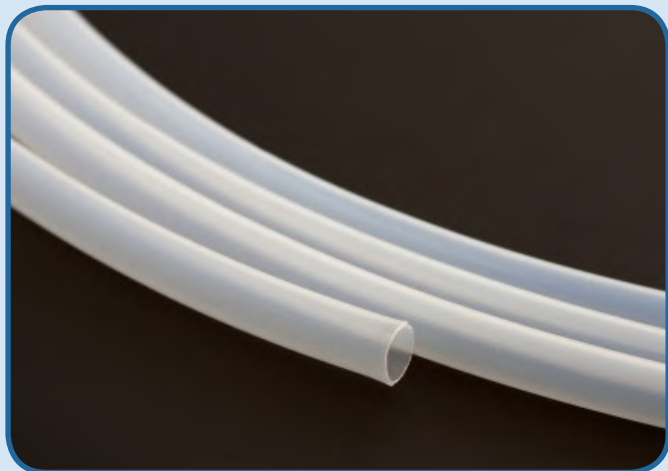

OD	ID	REFERENCE	QUANTITY
1/4"	6,3 mm	TP14	1 meter
3/16"	3 mm	TP316	1 meter
1/8"	1,6 mm	TP18	1 meter
1/16"	1,0 mm	TP16	1 meter

TYGON™ TUBES

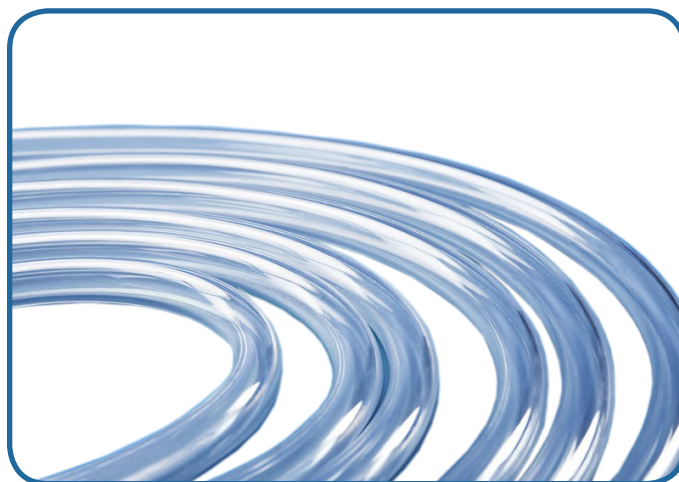

OD	ID	REFERENCE	QUANTITY
9,5 mm	6,4 mm	TYG-64	1 meter
19,1 mm	12,7 mm	TYG-127	1 meter

BLIND PLUGS

THEY CLOSE THE UNUSED INLETS OF YOUR SMART WASTE CAPS



FOR	REFERENCE	QUANTITY
1/8" or 1/16" fitting	VP-F18	Per 10
Threaded barbed fitting	VP-LEAK	Per 5
Charcoal cartridge fitting	VP-CA	Unit

SMART WASTE CAPS

ACCESSORIES : QUICK CONNECT FITTINGS



SMART HEALTHY CAPS OR SMART WASTE CAPS WITH QUICK CONNECT FITTINGS (WITH OR WITHOUT SHUTOFF VALVE)

Create your own reference!

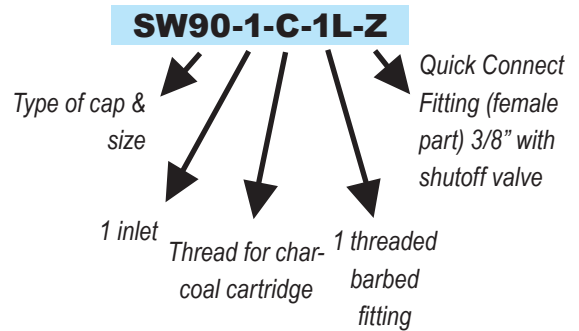

A = Height/Diameter (mm)
 B = Total length (mm)
 D = Elbow radial length (mm)

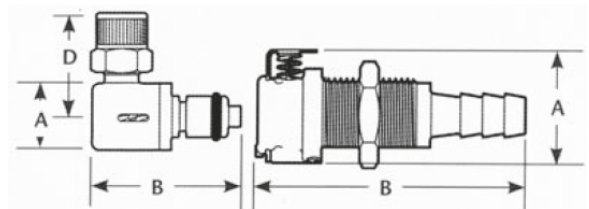

FEMALE PART

DESCRIPTION	OUTLET	PASSAGE	REFERENCE	A	B
Quick Connect (female part) without shutoff valve	1/16" (1,6 mm)	3,2mm	S	22,35	35,56
	1/8" (3,2 mm)	3,2mm	T	22,35	41,91
	1/4" (6,4 mm)	3,2mm	U	22,35	46,99
	3/8" (9,5mm)	6,4mm	V	25,40	49,53
Quick Connect (female part) with shutoff valve	1/16" (1,6 mm)	3,2mm	W	22,35	35,56
	1/8" (3,2 mm)	3,2mm	X	22,35	41,91
	1/4" (6,4 mm)	3,2mm	Y	22,35	46,99
	3/8" (9,5mm)	6,4mm	Z	25,40	49,53

ASK US FOR ADVICE FOR YOUR CUSTOM CONFIGURATIONS!

SMART WASTE CAPS





ACCESSORIES : QUICK CONNECT FITTINGS

CHOOSE THE MALE QUICK CONNECT FITTING THAT BEST SUITS YOUR NEEDS AND MODULATE THE CONNECTION ACCORDING TO YOUR WISHES.

MALE PART

SW55-C-Z &
QC64-38-CD



TERMINATION	OUTLET	PASSAGE	REFERENCE WITH SHUTOFF	REFERENCE NO SHUTOFF	A	B	D
	1/16" (1,6mm)	3,2mm	QC32-116-CD-C	QC32-116-CD	12,70	20,32/ 37,34	-
	1/8" (3,2mm)	3,2mm	QC32-18-CD-C	QC32-18-CD	12,70	26,67/ 42,42	-
	1/4" (6,4mm)	3,2mm	QC32-14-CD-C	QC32-14-CD	12,70	30,48/ 43,43	-
	1/4" (6,4mm)	3,2mm	QC32-14-CC-C	QC32-14-CC	12,70	27,69/ 30,73	22,86
	1/4-28	3,2mm	QC32-14-TFP-C	QC32-14-TFP	18,29	39,37	-
	1/4" (6,4mm)	6,4mm	QC64-14-CD-C	QC64-14-CD	16,00	34,29/ 50,80	-
	3/8" (9,5mm)	6,4mm	QC64-38-CD-C	QC64-38-CD	16,00	34,29/ 46,23	-
	1/4" (6,4mm)	6,4mm	QC64-14-CC-C	QC64-14-CC	16,00	30,99/ 34,54	24,38
	3/8" (9,5mm)	6,4mm	QC64-38-CC-C	QC64-38-CC	16,00	32,51/ 36,06	24,38

BEWARE : MALE / FEMALE COMPATIBILITY IS ONLY ENSURED IF THE PASSAGE DIAMETER IS THE SAME FOR BOTH PARTS!

SAFETY FUNNELS

A WIDE RANGE TO MEET ALL YOUR NEEDS



SAFETY FUNNELS

A WIDE RANGE TO MEET ALL YOUR NEEDS



SAFETY FUNNELS

FUNNEL WITH HINGED LID FOR RESIDUAL SOLVENTS

It is installed on a can or a barrel of residual solvent. It is practical and you can equip it with an activated charcoal cartridge if the storage is in a non-ventilated room. The activated charcoal cartridge prevents the creation of an overpressure in the can if it is exposed to heat.



DESCRIPTION

REFERENCE WITH CARTRIDGE*

REFERENCE WITH-OUT CARTRIDGE

DESCRIPTION	REFERENCE WITH CARTRIDGE*	REFERENCE WITH-OUT CARTRIDGE
Smart Waste Caps funnel with hinged lid for can S55	SW55-FSC	SW55-FSB
Smart Waste Caps funnel with hinged lid for can S60	SW60-FSC	SW60-FSB
Smart Waste Caps funnel with hinged lid for can S90	SW90-FSC	SW90-FSB
Smart Waste Caps funnel with hinged lid for space-saving can S50	SWB-FSC	SWB-FSB
Smart Waste Caps funnel with hinged lid for metallic barrel	SWBA-FSC	SWBA-FSB

*Activated charcoal cartridge sold separately (see page 24)

SAFETY FUNNELS

FUNNEL WITH HINGED LID FOR RESIDUAL SOLVENTS

This funnel has a double interest: the direct discharge through the funnel of all your waste, but also the collection of effluent from your HPLC systems with the integration of inlet fittings and / or threaded barbed fittings on the funnel.

DESCRIPTION	THREAD	REFERENCE
Funnel with hinged lid with 1 activated charcoal cartridge, 2 inlets 1/8" (3.2mm) and 1 threaded barbed fitting (6 to 9mm)	S55	SW55-2-1L-FSC
	S60	SW60-2-1L-FSC
	S90	SW90-2-1L-FSC
	Metallic barrel	SWBA-2-1L-FSC
	Space-saving can	SWB-2-1L-FSC
Funnel with hinged lid with 1 activated charcoal cartridge, 2 inlets 1/8" (3.2mm) and 2 threaded barbed fittings (6 to 9mm)	S55	SW55-2-2L-FSC
	S60	SW60-2-2L-FSC
	S90	SW90-2-2L-FSC
	Metallic barrel	SWBA-2-2L-FSC
	Space-saving can	SWB-2-2L-FSC
Funnel with hinged lid with 1 activated charcoal cartridge, 2 inlets 1/8" (3.2mm) and 3 threaded barbed fittings (6 to 9mm)	S55	SW55-2-3L-FSC
	S60	SW60-2-3L-FSC
	S90	SW90-2-3L-FSC
	Metallic barrel	SWBA-2-3L-FSC
	Space-saving can	SWB-2-3L-FSC



*Activated charcoal cartridge sold separately (see page 24)

Create your own reference !

SW55 - 2 - 2L - FSC

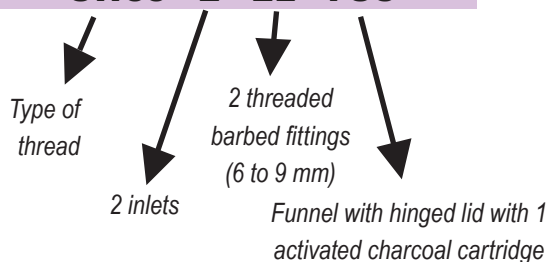

For any special configuration (exemple : 2 entries of different diameters), contact us directly !

SAFETY FUNNELS

FUNNEL WITH STOPCOCK

It secures the storage of your residual solvents, equipped with an activated charcoal cartridge for filtration of unobstructed vapors. It is possible to add entries and / or threaded barbed fittings by creating your own reference (see below).

FOR CANS	REFERENCE
S51/55	SW55-C-FS
S60/61	SW60-C-FS

Create your own reference !

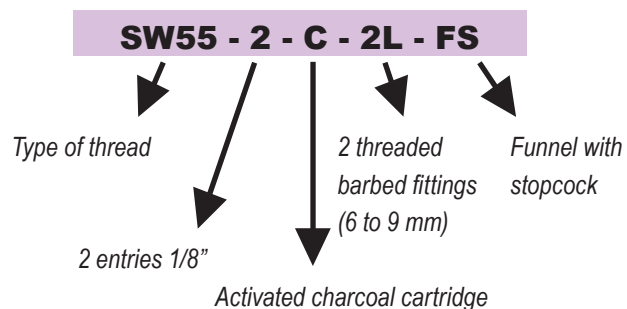

SW55-C-FS

Note : Standard references are not equipped with additional inlets. For another configuration, follow the explanation above and create your own reference!

SAFETY FUNNEL

FUNNEL WITH BALL VALVE WITH HIGH SPILL CAPACITY

Funnel with ball valve allowing to quickly pour used solvents, for plastic can from 5 to 50L.



Funnel with ball valve with activated charcoal cartridge



Funnel with ball valve without activated charcoal cartridge

DESCRIPTION	REFERENCE WITHOUT CARTRIDGE	REFERENCE WITH CARTRIDGE *
Funnel with ball valve for can S55	ET55-B	ET55-C-B
Funnel with ball valve for can S60	ET60-B	ET60-C-B
Funnel with ball valve for can S90	ET90-B	ET90-C-B
Funnel with ball valve for space-saving can S50	ETB-B	ETB-C-B
Funnel with ball valve for metallic barrel	ETBA-B	ETBA-C-B

* Activated charcoal cartridge are to be ordered separately

SAFETY FUNNEL

FUNNEL WITH BALL VALVE WITH SMART WASTE CAP FUNCTION

Funnel with ball valve for 5 to 20L can and metallic barrel, with or without external solvent inlet. It can be equipped with the same functions as a conventional Smart Waste Cap (threaded barbed fittings, activated charcoal cartridge, inlets) to directly receive the effluent from your HPLC chains without passing through the funnel.

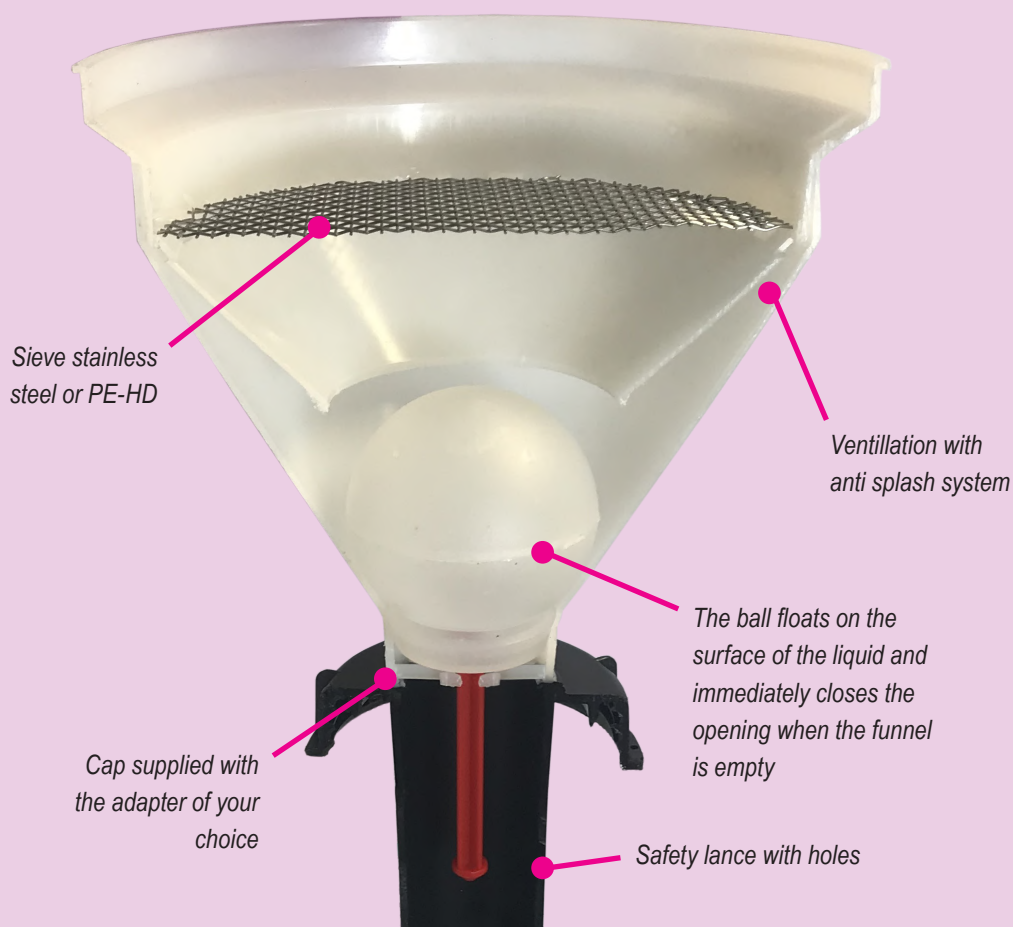

Funnels with ball valve with activated charcoal cartridge



ET55-3-C-1L

For any other configuration, contact us directly!

DESCRIPTION	THREAD	REFERENCE
Funnel with ball valve with an adapter for the activated charcoal cartridge, 2 fittings 1/8" and 1 threaded barbed fitting (6 to 9 mm)	S55	ET55-2-C-1L
	S60	ET60-2-C-1L
	S90	ET90-2-C-1L
	NALGENE® B83	ETB83-2-C-1L

SAFETY FUNNEL

FUNNEL WITH BALL VALVE WITH HIGH SPILL CAPACITY AND CARTRIDGE OF ACTIVATED CHARCOAL FOR METALLIC BARREL

DESCRIPTION	REFERENCE
Funnel with ball valve for metallic or plastic barrel	ETBA-B
Funnel with ball valve for metallic or plastic barrel + 1 threaded barbed fitting (6 to 9 mm)	ETBA-1L
Funnel with ball valve for metallic or plastic barrel + 2 threaded barbed fittings (6 to 9 mm)	ETBA-2L
Activated charcoal cartridge of 250 gr for a metallic barrel of 50 L Thread*: 2" for the large bung and 3/4" for the small bung	FC-250
Activated charcoal cartridge of 500 gr for a metallic barrel of 200 L Thread*: 2" for the large bung and 3/4" for the small bung	FC-500

* For other types of thread on your barrel, please contact us directly.



DESCRIPTION	REFERENCE
Sieve in polyhethylene (HD-PE)	TAM-PE *
Sieve in stainless steel	TAM-LUX *



* Add the option reference at the end of the funnel reference.

SAFETY FUNNEL

ELECTRO CONDUCTIVE FUNNEL

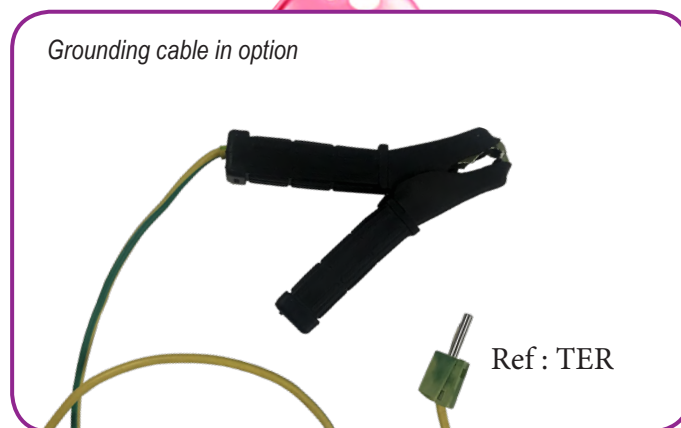

DESCRIPTION	THREAD	REFERENCE
Electro conductive funnel with ball valve equipped with a stainless steel sieve	S55	ET55-B-EL
	S60	ET60-B-EL
	S90	ET90-B-EL
	NALGENE® B83	ETB83-B-EL
Electro conductive funnel with ball valve equipped with a stainless steel sieve and an adapter for an activated charcoal cartridge	S55	ET55-C-EL
	S60	ET60-C-EL
	S90	ET90-C-EL
	NALGENE® B83	ETB83-C-EL

ELECTRO CONDUCTIVE CANS



VOLUME (LITER)	THREAD	REFERENCE
10	S60 / DIN 61	B10-61-EL
20	S60 / DIN 61	B20-61-EL
30	S60 / DIN 61	B30-61-EL

SINK FOR BIOLOGICAL LABORATORIES

This vat is used to make colorations for example, with flowage directly connected to your waste container, on which it is possible to add a safety funnel. This solution allows you to avoid any decanting.

Also for the laboratories of :
- Parasitology
- Bacteriology
- Hematology
- Microbiology



REFERENCE

DIMENSION (MM)

CV-HIST

L. 410 x H. 125 x D. 335

RETENTION TRAYS & CANS

CANS IN HD-PE CHEMICALLY INERT

VOLUME (LITER)	THREAD	DIMENSION (MM) HxLxD	REFERENCE
2,5 L	GL45	203 x 153 x 115	B2-45
5 L	GL45	254 x 192 x 145	B5-45
5 L	S55	235 x 182 x 162	B5-55
10 L	S55	310 x 230 x 198	B10-55
20 L	S60 / DIN 60	386 x 290 x 259	B20-60

How to determine the thread of your can?

* S = ISO's norm

* DIN = DIN's norm

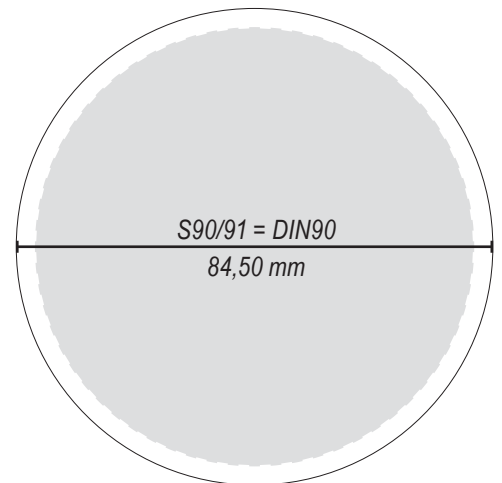
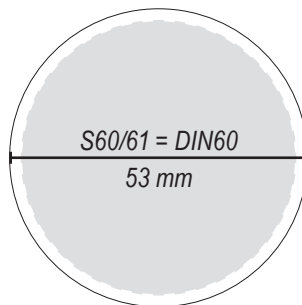
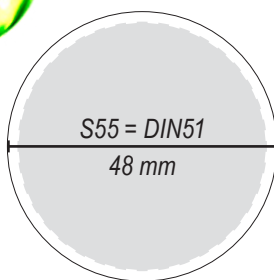

LOOSENING WRENCH



RETENTION TRAYS & CANS

RETENTION TRAYS

Avoid accidental overflow. A.I.T offers 2 models of retention trays. With grid or with duckboard to keep the can dry.



DESCRIPTION	DIMENSION (MM)		CAPACITY	REFERENCE
	EXTERNAL	INTERNAL		
Little Retention Tray with a grid	H.70 × L.347 × I.230	L.280 × I.165	3L	BAC-R-3
Medium Retention Tray with a grid	H.75 × L.437 × I.285	L.380 × I.220	5L	BAC-R-5
Large Retention Tray with a grid	H.75 × L.485 × I.335	L.420 × I.265	8L	BAC-R-8

H : height
W : width
D : depth

DESCRIPTION	DIMENSION (MM)	REFERENCE
Retention Tray 5L with duckboard	H.45 × L.445 × I.415	BAC-R-5-CAIL
Retention Tray 10L with duckboard	H.90 × L.445 × I.415	BAC-R-10-CAIL



SPACE-SAVING CANS IN HD-PD

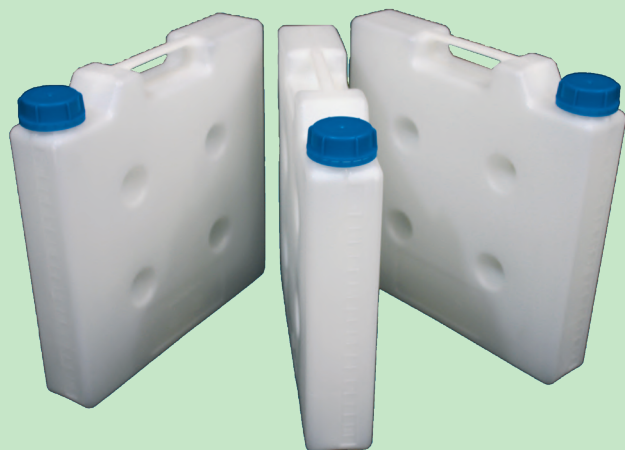

BS-GP

VOLUME (LITRES)	THREAD
5	GL45
DIMENSIONS (MM) EXT.	REFERENCE
H. 335 x L. 335 x I. 65	BS-GP

INDEX

REFERENCE	PAGE	REFERENCE	PAGE	REFERENCE	PAGE
AD-14-28	26	B10-61-EL	58	ET55-B	55
AD-2T-GL45	18	B20-60	60	ET55-B-EL	58
AD-32-45-P	20	B20-61-EL	58	ET55-C-B	55
AD-32-45-T	20	B2-45	60	ET55-C-EL	58
AD-38-45-T	20	B30-61-EL	58	ET60-2-C-1L	56
AD-38-45-P	20	B5-45	60	ET60-B	55
AD-40-32-P	40	B5-55	60	ET60-B-EL	58
AD-40-38-P	40	BAC-R-10-CAIL	61	ET60-C-B	55
AD-40-45-P	20, 40	BAC-R-3	61	ET60-C-EL	58
AD-40-45-T	20	BAC-R-5	61	ET90-2-C-1L	56
AD-45-32-P	40	BAC-R-5-CAIL	61	ET90-B	55
AD-45-38-P	40	BAC-R-8	61	ET90-B-EL	58
AD-45-55-P	40	BS-GP	61	ET90-C-B	55
AD-45-EM	12	CC-ONE-1BL	23, 41	ET90-C-EL	58
AD45-PAIL-1L	38	CC-ONE-1V	23, 41	ETB83-2-C-1L	56
AD-4T-GL45	18	CC-ONE-2BL	23, 41	ETB83-B-EL	58
AD-4T-GL80-GL45	18	CC-ONE-2V	23, 41	ETB83-C-EL	58
AD-55-60-P	40	CR-1	46	ETBA-1L	57
AD-55-45-P	40	CR-3	46	ETBA-2L	57
AD-60-55-P	40	CR-6	46	ETBA-B	55, 57
AD-CPC	29	CV-HIST	59	ETBA-C-B	55
AD-D-JUST	29	DIS 10	13	ETB-B	55
AD-VL	26	DIS 25	13	ETB-C-B	55
B10-55	60	ET55-2-C-1L	56	F14	24

INDEX

REFERENCE	PAGE	REFERENCE	PAGE	REFERENCE	PAGE
F16	24	GL250-C	21	QC32-14-CC-C	49
F16-1	24	GL5000-A	21	QC32-14-CD	49
F18	24	GL5000-C	21	QC32-14-CD-C	49
F18-25	24	GL500-A	21	QC32-14-TFP	49
F316	24	GL500-C	21	QC32-14-TFP-C	49
FC-100	26	KEY-55-60	60	QC32-18-CD	49
FC-100-H2SO4	26	KITB-4SHC-2	11	QC32-18-CD-C	49
FC-100-KOH	26	KITB-5SHC-2	11	QC64-14-CC	49
FC-180	28	KIT-SHC-1	10	QC64-14-CC-C	49
FC-25	26	KIT-SHC-2	10	QC64-14-CD	49
FC-250	57	KIT-SHC-3	10	QC64-14-CD-C	49
FC-50	26	KIT-SW45	43	QC64-38-CC	49
FC-500	57	KIT-SW50	43	QC64-38-CC-C	49
FC-50-C	26	KIT-SW55	43	QC64-38-CD	49
FC-50-MS	27	KIT-SW60	43	QC64-38-CD	49
FC-90	28	MULTIMOL-8-2L	38	QC64-38-CD-C	49
FC-AD-CPC	29	QC32-116-CD	49		
FC-AD-JUST	29	QC32-116-CD-C	49		
FC-D	28	QC32-14-CC	49		
GL1000-A	21				
GL1000-C	21				
GL2000-A	21				
GL2000-C	21				
GL250-A	21				

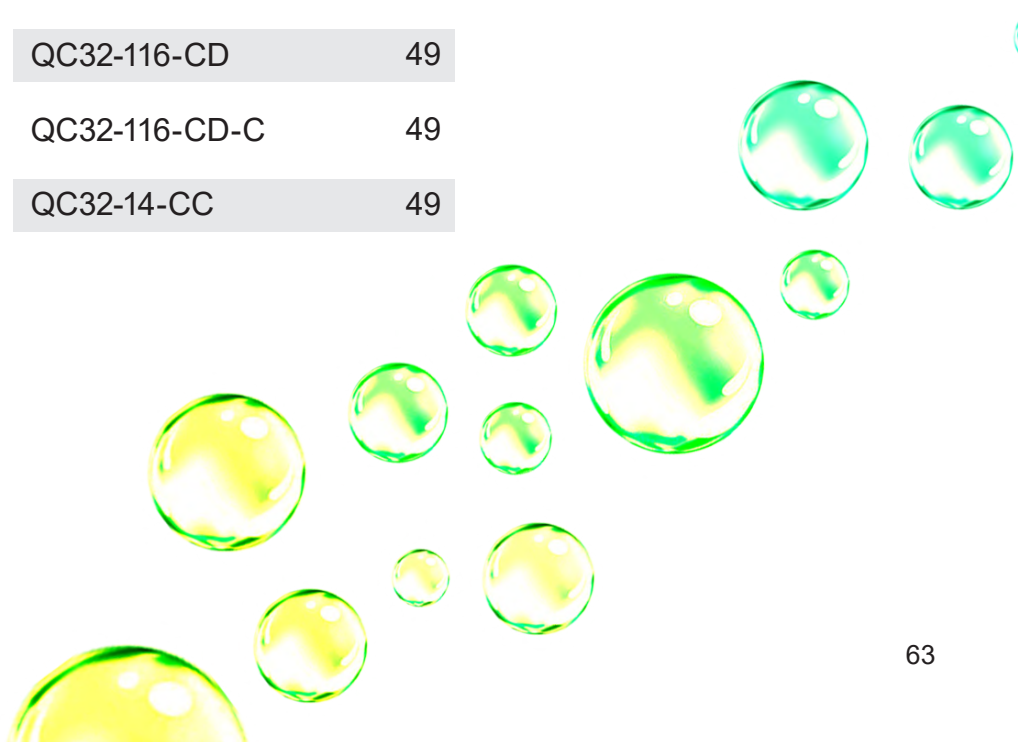

INDEX

REFERENCE	PAGE	REFERENCE	PAGE
R14	24	SHCB53-FSP-A	17
R16	24	SHCB53-FSP-C	17
R18	24	SHCB53-FSP-B	17
R316	24	SHCBA-FSP-A	17
RC-34	45	SHCBA-FSP-C	17
RC-56	45	SHCBA-FSP-B	17
RC-69	45	SHC-1-EM	13
RC-911	45	SHC-P-A	15
RCY-56	45	SHC-P-B	15
RCY-69	45	SHC-1PV	13
RD-34	45	SHC-1-SEPT	14
RD-56	45	SHC-2	9
RD-69	45	SHC-2-EM	13
RD-911	45	SHC-P-A-C	15
SHC-1	9	SHC-P-2B	15
SHC45-FSP-A	17	SHC-2PV	13
SHC45-FSP-C	17	SHC-2-SEPT	14
SHC45-FSP-B	17	SHC-3	9
SHC55-FSP-A	17	SHC-3-EM	13
SHC55-FSP-C	17	SHC-3PV	13
SHC55-FSP-B	17	SHC-3-SEPT	14
SHC60-FSP-A	17		
SHC60-FSP-C	17		
SHC60-FSP-B	17		

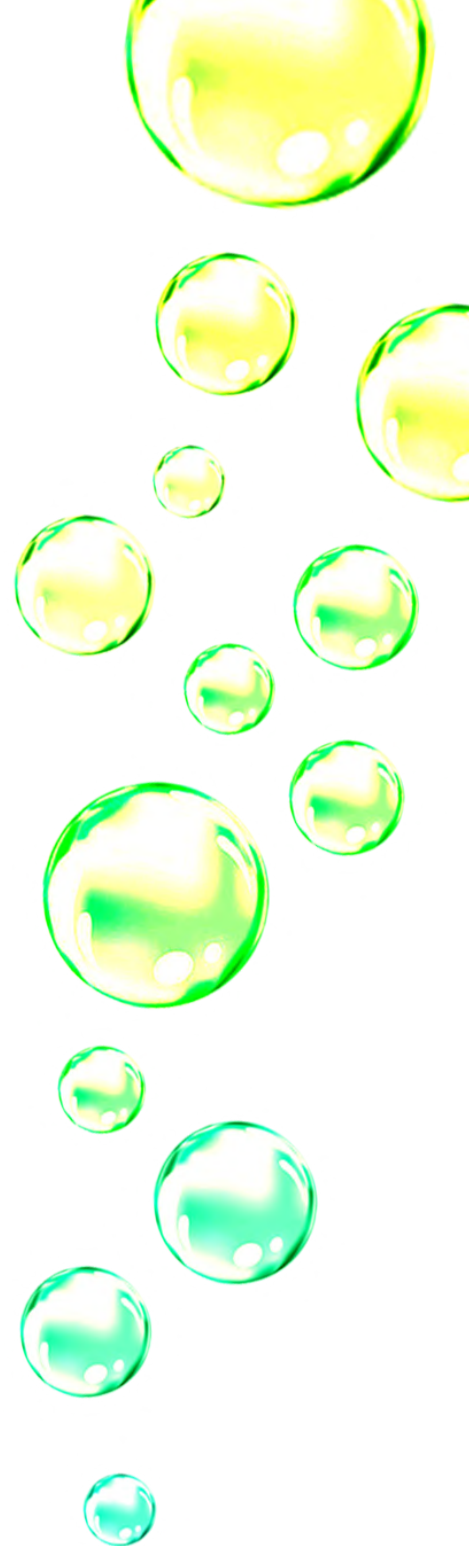

INDEX

REFERENCE	PAGE	REFERENCE	PAGE	REFERENCE	PAGE
SHC-4	9	SW45-1-C-1L	32	SW55-FSC	52
SHC-4-EM	13	SW45-1-C-2L	32	SW55-MS	27
SHC-4PV	13	SW45-2-C-1L-LI	37	SW60-1-C-1L	34
SHC-5	9	SW45-2-C	32	SW60-1-C-4L	34
SHC55-P-A	16	SW45-2-C-2L	32	SW60-2-1L-FSC	53
SHC55-P-A-B	16	SW45-4-C-1L	32	SW60-2-2L-FSC	53
SHC55-P-A-C	16	SW45-5-C	32	SW60-2-3L-FSC	53
SHC55-P-B	16	SW45-C-2L	32	SW60-2-C	34
SHC55-P-2A-B	16	SW45-C-3L	32	SW60-2-C-1L	34
SHC55-P-3A	16	SW45-MS	27	SW60-2-C-4L	34
SHC60-P-A	16	SW55-1-C-1L	31	SW60-5-C-1L	34
SHC60-P-A-C	16	SW55-1-C-3L	31	SW60-6-C	34
SHC60-P-B	16	SW55-2-1L-FSC	53	SW60-C-1L	34
SHC-SV	22	SW55-2-2L-FSC	53	SW60-C-FS	54
SHC-SV10	22	SW55-2-3L-FSC	53	SW60-FSB	52
SHC-SV50	22	SW55-2-C-2L	31	SW60-FSC	52
SHC-SV-AB	22	SW55-3-C-2L	31	SW60-MS	27
SHC-SV-AB10	22	SW55-3-C-3L	31	SW90-1-C-1L-Z	48
SHC-SV-AB50	22	SW55-4-C	31	SW90-2-1L-FSC	53
SHC-SV-PREP	22	SW55-4-C-1L	31	SW90-2-2L-FSC	53
SHC-V1	12	SW55-5-C	31	SW90-2-3L-FSC	53
SHC-V2	12	SW55-C-Z	49	SW90-1-C-2L	35
SHC-V3	12	SW55-C-FS	54	SW90-C-2L	35
SHC-V4	12	SW55-FSB	52	SW90-C-5L	35

INDEX

REFERENCE	PAGE	REFERENCE	PAGE
SW90-3-C-2L	35	SWBA-2-1L-FSC	53
SW90-4-C-1L	35	SWBA-2-2L-FSC	53
SW90-4-C-4L	35	SWBA-2-3L-FSC	53
SW90-FSB	52	SWBA-FSB	52
SW90-FSC	52	SWBA-FSC	52
SWB-1-C-1L	33	SWB-FSB	52
SWB-1-C-3L	33	SWB-FSC	52
SWB-2-1L-FSC	53	TAM-LUX	57
SWB-2-2L-FSC	53	TAM-PE	57
SWB-2-3L-FSC	53	TER	58
SWB-2-C-1L	33	TP16	25, 47
SWB-3-C	33	TP14	25, 47
SWB-5-C	33	TP18	25, 47
SWB-5-C-1L	33	TP316	25, 47
SWB53-2-C	36	TYG-127	25, 47
SWB53-4-C-1L	36	TYG-64	25, 47
SWB53-C-1L	36	VP-CA	47
SWB53-C-3L	36	VP-F18	24, 47
SWB53-MS	27	VP-LEAK	47
SWB83-2-C	36	Y-11	46
SWB83-4-C-1L	36	Y-3	46
SWB83-C-1L	36	Y-5	46
SWB83-C-3L	36	Y-7	46
SWB83-MS	27	Y-9	46

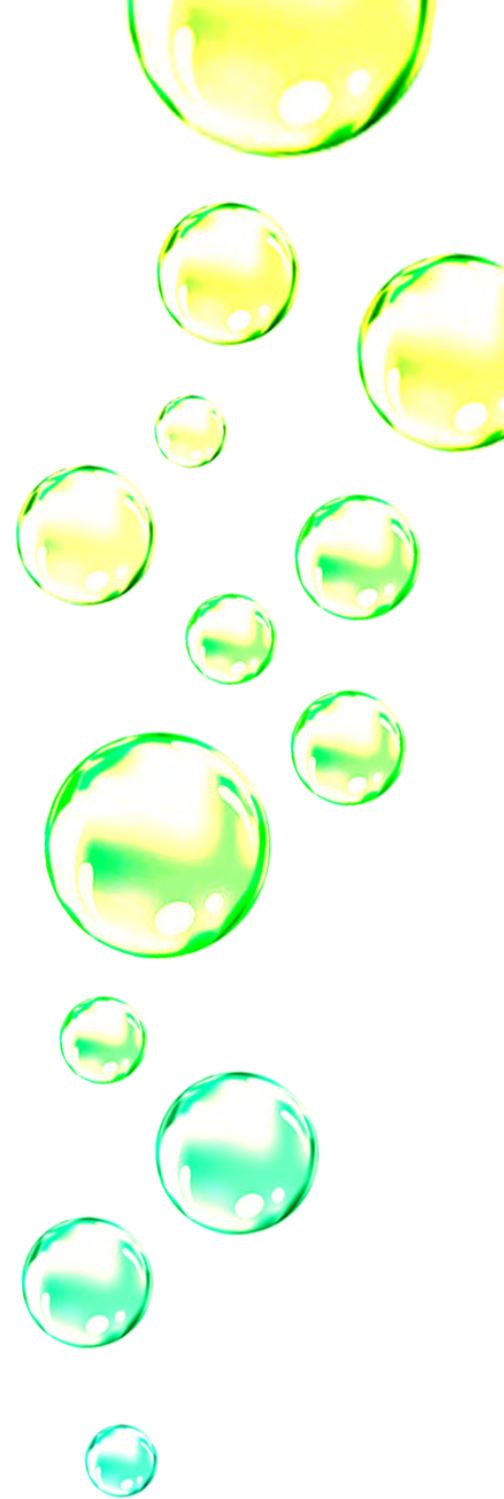



Sede di Milano - via neera 8/a - 20141 Milano - tel. +39 02.8954201 fax +39 02.89542022
Sede di Roma - l.go Leopardi 12 - 00185 Roma - tel. +39 06.4742104 fax +39 06.4742108
www.cps.it - cps@cps.it